



利達



LEADER

俊和 - 利達聯營

CHUN WO - LEADER JOINT VENTURE

Our Ref.: CL0907/03.09.00.00/13929/L

Date: 4 November 2015

**Environmental Protection Department  
Branch Office**

27th Floor, Southorn Centre  
130 Hennessy Road,  
Wan Chai, Hong Kong.

By Post

**Attention: Mr. Billy Ma**

Dear Sir,

**Contract No. HK/2009/01**

**Wan Chai Development Phase II – Central -Wan Chai Bypass at  
Hong Kong Convention and Exhibition Centre  
Updated Silt Screen Deployment Plan (Rev. 9)**

Pursuant to Further Environmental Permit No.: FEP-02/356/2009 – Condition 2.9 Silt Screen Deployment Plan, we would like to submit herewith 2 hardcopies and 1 electronic copy of Silt Screen Deployment Plan (Rev. 9) for your reference and comment. Please be noted that the aforementioned plan has been certified and verified by ET / IEC respectively.

Should you have any queries, please do not hesitate to contact our Ms. Wendy Ng at 9803 0057.

Thank you for your kind attention.

Yours faithfully

For and on behalf of

**Chun Wo - Leader Joint Venture**

**Andy Yu**  
Site Agent  
WV/KMN

Encl.

c.c. AAAL – H.O.

AECOM – Ms. Gloria Tang

LAM / ETL – Mr. Raymond Dai

ENVIRON / IEC – Mr. David Yeung

**Chun Wo -Leader Joint Venture**

Site Office Correspondence Address: P.O. Box No. 28947 Gloucester Road post office

Tel: (852) 2587 1900 Fax: (852) 2587 1878

Date - 9 NOV 2015					
Job No. G1120 E-C1					
	Action	Inform	Filing	Initial	Remarks
PL					
SK					
LW					
CM					
SY					
RW					
RD			✓		
Skai					
TB					
AL/SC		✓			

Ref.: AACWBIECEM00\_0\_7358L.15

3 November 2015

Chun Wo – Leader Joint Venture  
P. O. Box No. 28947  
Gloucester Road Post Office  
Hong Kong

By Post

Attention: Mr. Andy Yu

Dear Mr. Yu,

**Re: Contract No. HK/2009/01  
Wan Chai Development Phase II - Central-Wan Chai Bypass at HKCEC  
Silt Screen Deployment Plan (Rev. 9)**

Reference is made to the captioned submission dated 15 October 2015 received by e-mail on 3 November 2015.

Please be informed that we have no adverse comment on the captioned submission. We hereby verified the submission in accordance with Condition 2.9 of FEP-02/356/2009.

Thank you for your attention and please do not hesitate to contact the undersigned should you have any queries.

Yours sincerely,



David Yeung  
Independent Environmental Checker

c.c. CEDD Attn: Mr. Stephen Lo  
AECOM Attn: Mr. Frankie Fan  
Lam Attn: Mr. Raymond Dai

by fax: 2577 5040  
by fax: 2587 1877  
by fax: 2882 3331

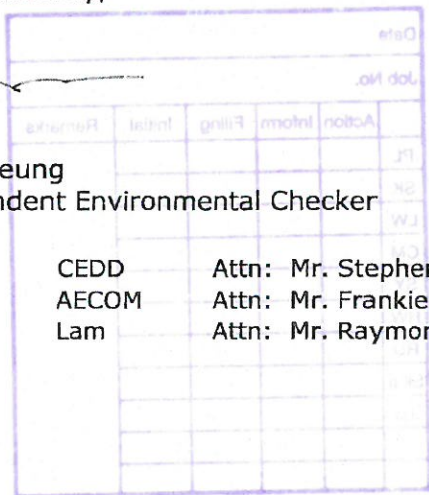

Q:\Projects\AACWBIECEM00\Corr\AACWBIECEM00\_0\_7358L.15.docx



# Lam Geotechnics Limited

Ground Investigation & Instrumentation Professionals

Ref : G1120/CS/L1127/CWLJV  
Date : 3 November 2015

**Chun Wo – Leader Joint Venture**  
P.O. Box No. 28947  
Gloucester Road Post Office  
Hong Kong

By Post

華益土力有限公司

**Attn: Andy Yu, Site Agent**

Dear Mr. Yu,

**Contract No. HK/2009/01**  
**Wanchai Development Phase II – Central –Wan Chai Bypass at HKCEC**  
**Silt Screen Deployment Plan (Rev.9)**

Referring to the captioned submission dated on 15 October 2015 received by email on 3 November 2015, we have reviewed your submitted details and hereby certified this submission in accordance with Condition 2.9 of FEP-02/356/2009.

Should you have any enquiry, please feel free to contact the undersigned at 2839 5666.

Yours faithfully,  
For and On Behalf of Lam Geotechnics Limited

Raymond Dai  
Environmental Team Leader

RD/Encl.

c.c. CEDD	- Mr. Stephen Lo	(By Fax: 2577 5040)
AECOM WDII	- Mr. Frankie Fan	(By Fax: 2587 1877)
Ramboll Environ	- Mr. David Yeung	(By Fax: 3465 2899)

11/F, Centre Point, 181-185 Gloucester Road, Wanchai, Hong Kong  
Tel: (852) 2882-3939  
Website: [www.lamgeo.com](http://www.lamgeo.com)

Fax: (852) 2882-3331  
Email: [info@lamgeo.com](mailto:info@lamgeo.com)



OHSAS 18001:2007  
Certificate No.: OC007



ISO 14001:2004  
Certificate No.: EC015



ISO 9001:2008  
Certificate No.: CC045



利達



俊和 - 利達聯營

CHUN WO - LEADER JOINT VENTURE

Contract No. HK/2009/01

Wan Chai Development Phase II – Central -Wan Chai Bypass at  
Hong Kong Convention and Exhibition Centre

## Silt Screen Deployment Plan

Revision	Date of Issue	Remarks	Author	Approved
0	19 Feb 10	Initial issue	DW	WTH
1	17 Mar 10	Incorporating comments from ET & IEC	DW	WTH
2	25 Mar 10	Incorporating comments from ET & IEC	DW	WTH
3	8 April 10	Incorporating comments from Engineer	DW	WTH
4	8 Nov 12	Updated Section. 2.1, Appendix A, B & F	AM	PY
5	12 July 13	Updated Section 1.1, 2.2,2.3, 4.2, Appendix A & H	AM	PLY
6	11 Aug 2014	Updated Section 1.1, 2.1, 4.2, Appendix A	KMN	SL
7	8 Oct 2014	Updated Section 1.1	KMN	SL
8	1 Sep 2015	Updated Section 1.1, 2.3, 4.5 and Appendix H	KMN	AYU
9	15 Oct 2015	Updated Section 1.1, 2.3, and Appendix H & I	KMN	AYU



## *Table of Content*

<i>Section</i>	<i>Subject</i>	<i>Pages</i>
	Title Page	1
	Table of Content	2
1	General	3
2	Silt Screen Design	4 – 5
3	Silt Screen Installation Procedure	5 – 8
4	Maintenance of Silt Screen	8 – 9
 <i>Appendix</i>		
A	Location Plan for Type 1 to 3 Silt Screen	10
B	Type 1 Silt Screen	11
C	Type 2 Silt Screen	12
D	Type 3 Silt Screen	13
E	Specification of proposed Geotextile for Type 1, 2 and 3 Silt Screens	14
F	Arrangement of Access Provision for Water Monitoring	15
G	Silt Screen Inspection Checklist	16
H	Programme for the Installation and Removal Of the Silt Screens	17
I	Communications Records	18
J	EPD's Comments	19

## **GENERAL**

### **1.1 Introduction**

Prior to the commencement of any dredging and backfilling works in the vicinity of the existing seawater intakes, silt screens have been installed to protect the cooling water intakes. The main contractor of HK/2009/01, Chun Wo – Leader Joint Venture (CWLJV) will be responsible for the installation, maintenance, repairing (if necessary) and removal of the silt screens.

Since the original silt screens of cooling water intake C2, C3 & C4W have been relocated to new pumping stations by CWLJV and the silt screens of cooling water intake C4E will be relocated to new pumping station upon the completion of new station by HK/2009/02 contractor, the revised deployment plan have been updated to include the information on latest silt screen arrangement.

Refer to EIA Report Section 5.8.16 and Table 5.39, the deployment of silt screens is also proposed at selected cooling water intakes and WSD seawater intakes. Since the dredging activities at HKCEC and WCR have been completed (Appendix I for the communication records), the removal of silt screens at C1, P1, P3, P4, P5, WSD7 and WSD19 will be carried out by CWLJV.

Programme for maintenance and removal of silt screens have been updated to reflect current status.

This deployment plan describes in details the design, method of installation, operation and maintenance of the proposed silt screen.

### **1.2 Reference Specification and Drawings**

- a) General Specification Section 21 & 25
- b) Particular Specification Section 21 & 25
- c) Contract Drawing nos. 60041297/C1/200/1836B, Figure 4 of EP-356/2009

### **1.3 Construction Plants**

The following plants shall be deployed:

- |                   |       |
|-------------------|-------|
| i) Crane Lorry    | 1 no. |
| ii) Mobile Crane  | 1 no. |
| iii) Motor Sampan | 1 no. |

Adequate resources shall be employed to suit the construction programme of silt screens.

#### 1.4 Safety

The works shall carry out in accordance with the Project Safety Plan and shall comply with the requirements of the Marine Department and Labour Department. Specific risk assessment shall be prepared and submitted separately.

## 2. Silt Screen Design

- 2.1 In general, there are three types of silt screen. Type 1 silt screen is designed for those seawater intakes located on vertical seawall, i.e. seawater intakes of Telecom House, HK Academy for Performing Arts, Shui On Centre, Wan Chai Tower / Revenue Tower, Immigration Tower, Great Eagle Centre, China Resources Building, Sogo Tsim Sha Tsui, WSD. Type 2 silt screen is designed for seawater intakes of Hong Kong Convention and Exhibition Centre located under the promenade deck. Type 3 silt screen is designed for the submarine seawater intake near Avenue of Stars. Silt screens of either Type 1, Type 2 or Type 3 depending on the actual site condition, will also be installed for WSD saltwater intakes at WSD7 (Kowloon South), WSD19 (Sheung Wan) or any other intakes as highlighted in EP-356/2009 Table 1 and Figure 4 subject to the site instruction from the Engineer. The location plans for Type 1 to 3 silt screens are enclosed in **Appendix A**.

All cooling water intake C2, C3 & C4W have been relocated to new pumping stations by CWLJV on or before 24 June 2013. Whereas, cooling water intake C4E will be relocated to new pumping station upon completion of new station by HK/2009/02 contractor. The location plan of seawater intakes is enclosed in **Appendix A**.

- 2.2 Type 1 silt screen consists of a steel frame and a layer of geotextile screening. The steel frame will be fixed to the vertical seawall by anchor bolts. The geotextile screening will be tied on to the steel frame by nylon ropes and attached to the vertical seawall on both top and bottom sides. A hinged opening will be provided at the top of the steel frame as access for water monitoring inside the silt screen. The layout and general arrangement of Type 1 silt screen is enclosed in **Appendix B**.
- 2.3 Type 2 silt screen consists of a layer of geotextile screening tied on 300mm diameter buoys and extended to the seabed level secured by steel chain ballast. The buoys will be further positioned by nylon ropes tied on existing structures. Type 2 silt screen will be installed underneath the perimeter of the promenade piled deck of the pump house of Hong Kong Convention and Exhibition Centre (HKCEC) Phase 1 and both ends of the silt screen will be attached to the vertical seawall adjacent to the promenade piled deck. The layout and general arrangement of Type 2 silt screen is enclosed in **Appendix C**. Alternatively, Type 1 silt screen will be installed for the intakes of HKCEC Phase 1 to replace Type 2 silt screen depending on the actual site condition during the course of the reclamation works. No matter Type 1 (for vertical seawall) or Type 2 silt screen (for promenade decking), they can function as a silt screen in all respects covering design installation, maintenance and removal, changes in seawall and reclamation configuration.
- 2.4 Type 3 silt screen consists of 2 types of silt screen namely 'standing type' and 'hanging type' combined together. Standing type consists of a steel frame and a layer of geotextile screening on all 3 sides of the steel frame. The top frame will not be covered by geotextile to allow sufficient flow of water into the intake. The steel frame will be placed to the seabed to surround the seawater intake. The steel frame will be further secured to the seabed by steel cable tied to concrete sinkers. Hanging type is similar to Type 2 silt screen consists of a layer of geotextile screening tied on 300mm diameter buoys and extended to below the top level of the standing type silt screen. The bottom of the hanging type silt screen will be tied to ballast steel chain. The purpose of the hanging type silt screen is to prevent silt from sucking into the intake through the top opening of the standing type silt screen. The layout and general arrangement of Type 3 silt screen is enclosed in **Appendix D**.



2.5 The specification of the proposed geotextile for Type 1, 2 and 3 silt screens is enclosed in **Appendix E**.

### 3 **Silt Screen Installation Procedure**

#### 3.1 Type 1 Silt Screen

3.1.1 To carry out an underwater conditional survey to locate the existing water intakes by diver.

3.1.2 To verify the location, depths and sizes of the intake pipes and measure the dimension and position of the silt screen and mountings required.

3.1.3 To prefabricate the steel frame with steel mesh for fencing as determined in the previous step.

3.1.4 To mitigate the corrosion by seawater, all steel members should be hop-dip galvanized and the plastic coated steel mesh will be use before prefabrication.

3.1.5 The fabrication works will follow the layout drawing (See **Appendix B**)

3.1.6 A temporary steel working platform will be erected on site for installation of the steel frame.

3.1.7 To prefabricate the steel frame with steel mesh for fencing as determined in the previous step.

3.1.8 To form the anchor's holes by air drill.

3.1.9 The upper steel plate footing with 4 nos. anchor bolts will pre-install on the existing seawall.

3.1.10 To separate each steel frame to two portions for transportation and assembly on site.

3.1.11 To use crane lorry for lifting and fixing the steel frame to the location.

- 3.1.12 The top level of the steel frame is approximate +3.00mPD.
- 3.1.13 To use a chain block pulley system for lifting the steel frame from the top of the seawall for installation adjustment.
- 3.1.14 To fix and weld the steel frame onto the pre-installed steel plates.
- 3.1.15 To fix the lower steel plate footings onto the existing seawall using anchor bolts.
- 3.1.16 To tie the geotextile screening with steel chain ballast on to the steel frame by nylon ropes.
- 3.1.17 The outer silt screen can be removed and replaced during maintenance by workers using a chain block pulley system for lifting the screen directly from the water.
- 3.2 Type 2 Silt Screen / Type 3 Silt Screen (Hanging Type)
- 3.2.1 To carry out an underwater condition survey to locate the existing seawater intakes by divers.
- 3.2.2 To verify the location, depths and sized of the intake pipes and measure the dimension and position of the silt screen and mountings required.
- 3.2.3 To tie the silt screen to the buoys and steel chain ballast before transportation.
- 3.2.4 To transport the silt screen to the location for fixing via a marine pontoon.
- 3.2.5 To tie the buoys to the railings of the promenade deck / existing structures with nylon ropes.
- 3.2.6 To put the buoys to the water and then slowly put the silt screen with the steel chain ballast into sea.
- 3.2.7 The silt screen can be removed and replaced during maintenance by workers using a chain block pulley system to lift the screen directly from

the water.

### 3.3 Type 3 Silt Screen (Standing Type)

- 3.3.1 Standing type silt screen shall be installed prior to the installation of hanging type silt screen.
- 3.3.2 To carry out an underwater conditional survey to locate the existing water intake by the divers.
- 3.3.3 To verify the location, depths and sizes of the intake pipes and measure the dimension and position of the silt screen and mountings required.
- 3.3.4 To prefabricate the steel frame with steel mesh for fencing as determined in the previous step.
- 3.3.5 To mitigate the corrosion by seawater, all steel members should be hot-dip galvanized and the plastic coated steel mesh will be used before prefabrication.
- 3.3.6 The fabrication works will follow the layout drawing (See **Appendix D**)
- 3.3.7 To prefabricate the steel frame with steel mesh for fencing as determined in the previous step.
- 3.3.8 To use a mobile crane for lifting and fixing the steel frame to the location. Divers will assist the positioning of the silt screen under the water.
- 3.3.9 To place the concrete sinkers to the seabed by mobile crane and tie the steel frame to the concrete sinkers with steel cables by divers.
- 3.3.10 The outer silt screen can be removed and replaced during maintenance by the divers.

## 4. **Maintenance of Silt Screen**

- 4.1 Site supervisors will check the condition of the silt screens daily during the course of the marine works. An inspection checklist (see Appendix

- G) will be prepared and filled in by the site supervisors accordingly. All checklists will be kept on site for record purpose. Divers will be deployed to check the condition of the Type 3 standing type silt screen regularly.
- 4.2 Nearby marine works will stop immediately if silt screens are found damaged. Type 1 and 2 silt screens will be lifted up from the water by a chain block pulley system and the damaged outer silt screen will be replaced by workers. Damaged outer silt screen of Type 3 silt screen shall be replaced by divers. Nearby marine works will resume after repairing of the damaged silt screens. (Nearby marine works was defined as works within the region 100m from the damaged silt screen)
- 4.3 Refuse around the silt screens will be collected at regular intervals on a daily basis so that water behind the silt screens will be kept free from floating debris.
- 4.4 Sufficient spare geotextile screening will be kept on site for replacing of damaged silt screens. The spare geotextile screening shall be kept in place to avoid direct contact with water and sunlight.
- 4.5 Silt screens maintenance works at C1, P1, P3, P4, P5, WSD7 and WSD19 will be continued before removal works. As liaised with relevant cooling water intakes owners and WSD, the removal of the installed silt screens namely C1, P1, P3, P4, P5, WSD7 and WSD19 has been agreed and will be conducted by CWLJV. See Appendix H for the programme details of installation and removal of the silt screens and Appendix I for the stakeholders' communications record.



**Appendix A**  
**Location Plan for Type 1 to 3 Silt Screen**

Legend

- C1 Hong Kong Convention and Exhibition Centre Extension
- P1 Hong Kong Convention and Exhibition Centre Phase 1
- P3 Hong Kong Academy for Performing Art
- P4 Shui On Centre
- P5 Government Buildings (Wan Chai Tower / Revenue Tower / Immigration Tower)

Proposed silt screen will be installed for intake:

Type 1 silt screen for intake C1, P1, P3, P4, P5, C2, C4W, C4E

Type 2 silt screen for intake C3

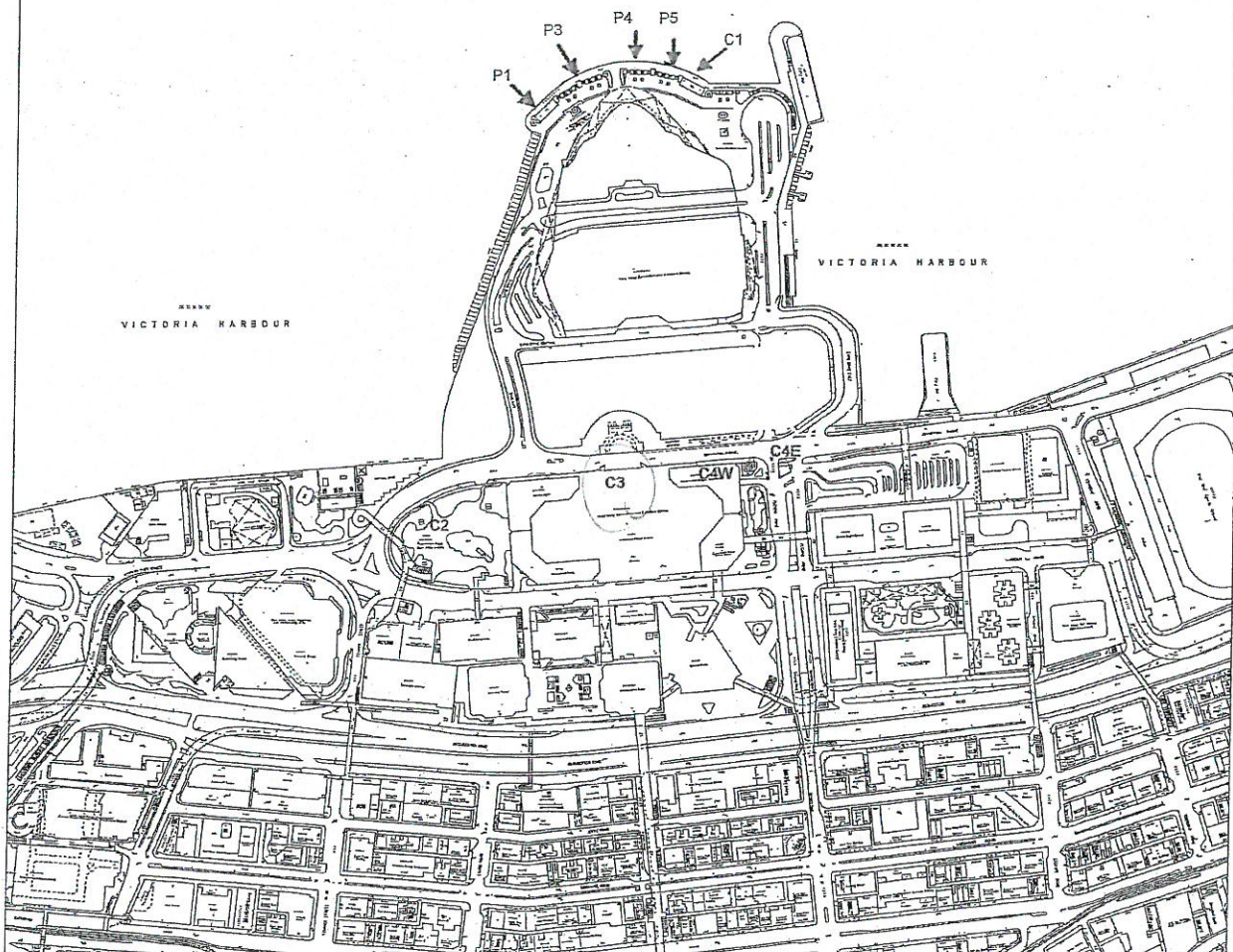

Project Title: Wan Chai Development Phase II and Central - Wan Chai Bypass at Hong Kong Convention and Exhibition Centre (Contract No.HK/2009/01)

Figure 1: Location Plans of Seawater Intakes

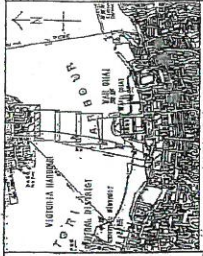

KEY PLAN  
SCALE 1:1,200

NOTE:  
1. REFER TO DRAWING NO. 60041297/C1/200/1835F FOR DETAILS AND LEGEND.

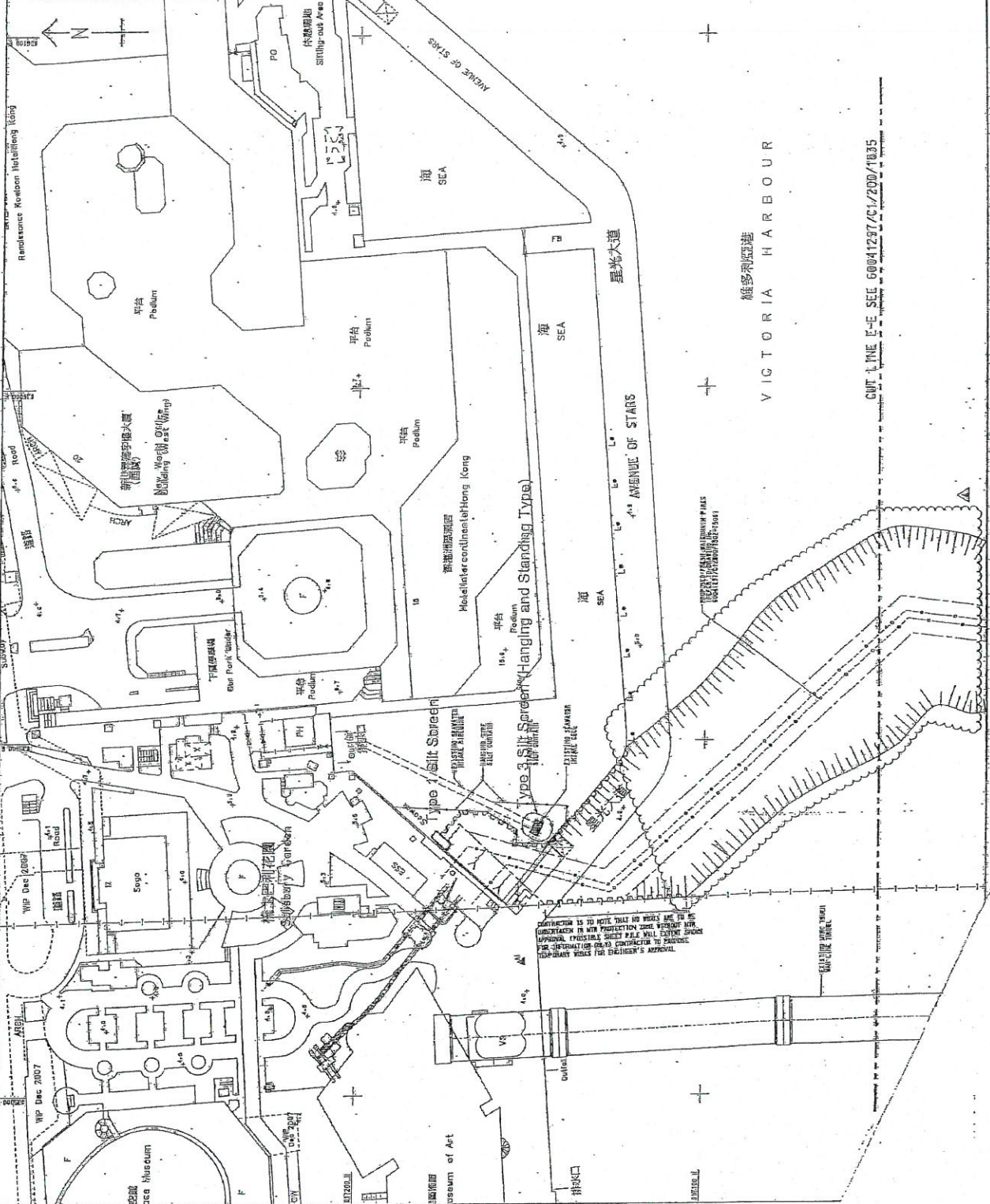

1. OWNER/CLIENT	香港政府
2. DESIGNER	香港政府
3. PREPARED BY	香港政府
4. DATE	2007
5. SCALE	1:1,200
6. PROJECT NO.	60041297/C1/200/1835F
7. SHEET NO.	1835F
8. SHEET TOTAL	1835F

WAN CHAI DEVELOPMENT PHASE II  
RECREATION AND LEISURE  
RENOVATION OF THE KOWLOON HOTEL CENTRE  
PROPOSED DREDGING PLAN  
SHEET 6 OF 6

**AECOM**

PROJECT NO. 60041297/C1/200/1835F  
SHEET NO. 1835F  
DATE 2007

WORKING DRAWING  
© COPYRIGHT RESERVED

CUT LINE E-E SEE 60041297/C1/200/1835

CONSTRUCTION IS TO BE DONE WITHIN THE PROTECTED AREA. THE PROTECTION SHALL BE MAINTAINED AT ALL TIMES. THE CONTRACTOR SHALL BE RESPONSIBLE FOR THE PROTECTION OF THE EXISTING STRUCTURES. THE PROTECTION SHALL BE MAINTAINED AT ALL TIMES. THE CONTRACTOR SHALL BE RESPONSIBLE FOR THE PROTECTION OF THE EXISTING STRUCTURES.



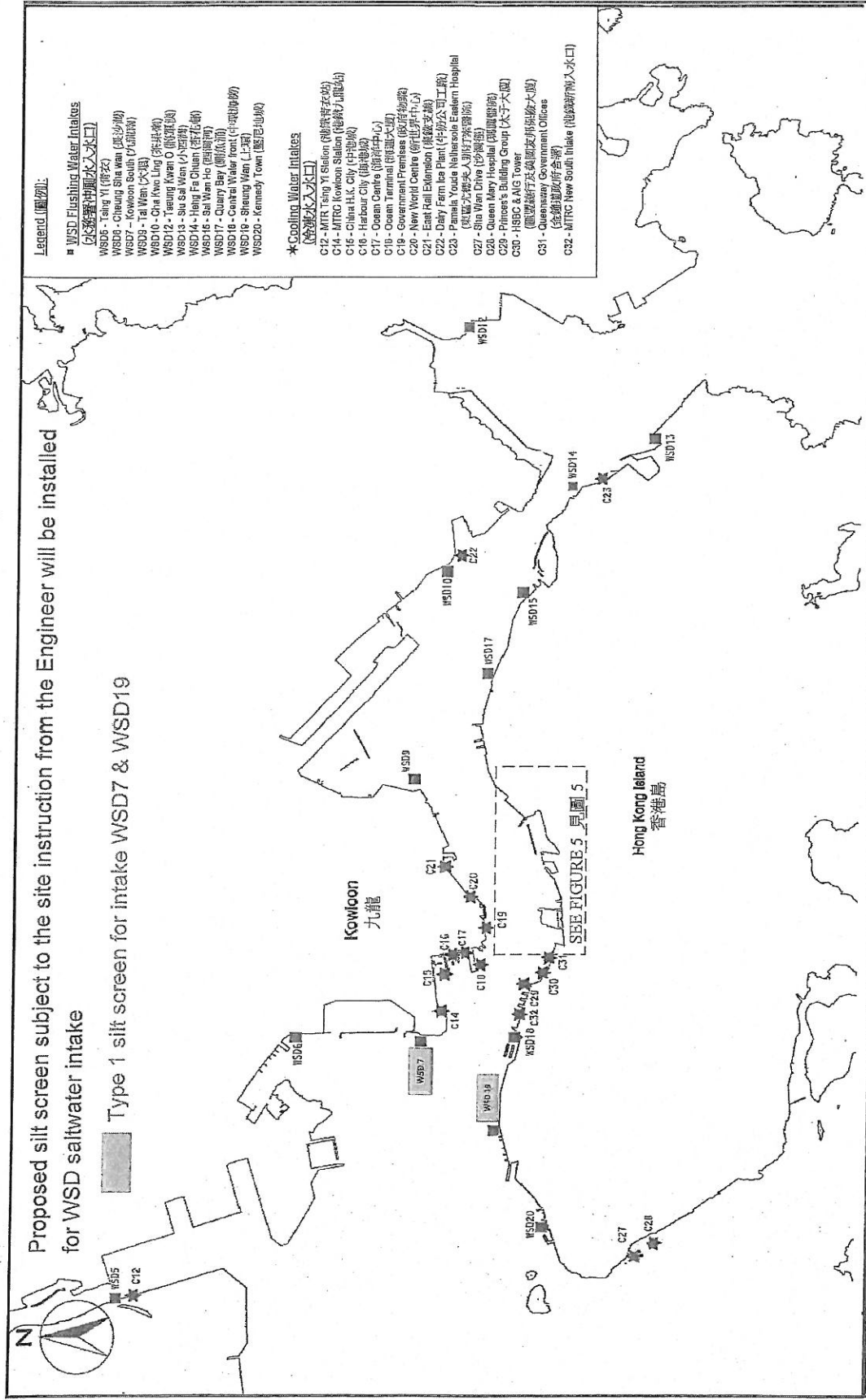

Figure 4: Indicative Location of Seawater Intakes  
 圖 4: 海水進水口參考位置圖  
 (This figure was prepared based on Figure 5.1 of the EIA report (Register No.: AEIAR-125/2008))  
 (本圖是根據環境評估報告 (登記冊編號 AEIAR-125/2008) 圖 5.1 編製)

Project Title: Wan Chai Development Phase II and Central - Wan Chai Bypass at Hong Kong Convention and Exhibition Centre (Contract No. HK/2009/01) - Marine Works  
 工程項目名稱: 灣仔發展計劃第二期及中環灣仔繞道 - 香港會議展覽中心段  
 (合約編號 HK/2009/01) - 海軍工程  
 Environmental Permit No.: FEP-02/356/2009  
 環境許可證編號 : FEP-02/356/2009





**Appendix B**  
**Type 1 Silt Screen**

1. ALL DIMENSIONS SHALL BE UNLESS OTHERWISE SPECIFIED.  
 2. ALL DIMENSIONS SHALL BE IN METERS UNLESS OTHERWISE SPECIFIED.  
 3. ALL DIMENSIONS SHALL BE IN METERS UNLESS OTHERWISE SPECIFIED.  
 4. ALL DIMENSIONS SHALL BE IN METERS UNLESS OTHERWISE SPECIFIED.  
 5. ALL DIMENSIONS SHALL BE IN METERS UNLESS OTHERWISE SPECIFIED.  
 6. ALL DIMENSIONS SHALL BE IN METERS UNLESS OTHERWISE SPECIFIED.  
 7. ALL DIMENSIONS SHALL BE IN METERS UNLESS OTHERWISE SPECIFIED.  
 8. ALL DIMENSIONS SHALL BE IN METERS UNLESS OTHERWISE SPECIFIED.  
 9. ALL DIMENSIONS SHALL BE IN METERS UNLESS OTHERWISE SPECIFIED.  
 10. ALL DIMENSIONS SHALL BE IN METERS UNLESS OTHERWISE SPECIFIED.

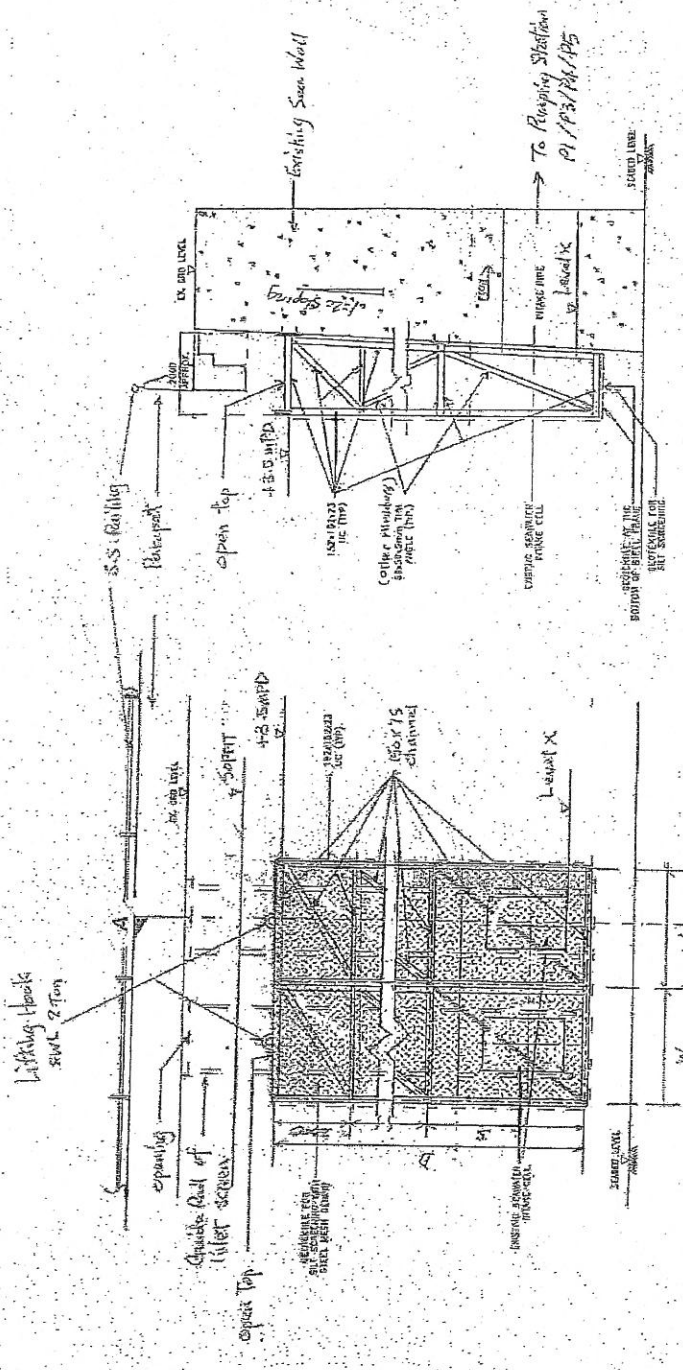

ELEVATION OF TYPICAL DETAILS FOR SILT SCREEN OVER INTAKE PIPES

(For Pumping Stations P1-P5)

SECTION A-A

DIMENSIONS OF TEMPORARY SILT SCREEN

Pumping Station	D	S	W	Qy	Levert Level X
P1	7.8 m	2.7 m	4.4 m Twin cell 2.5 m Single cell	3 nos. 2 nos.	+4.077 mPD
P2	7.8 m	2.5 m	4.4 m Twin cell 2.5 m Single cell	2 nos. 2 nos.	-4.316 mPD
P3	6.9 m	2.4 m	4.4 m Twin cell 2.5 m Single cell	1 no. 2 nos.	-5.332 mPD
P5	6.9 m	2.4 m	4.4 m Twin cell 2.5 m Single cell	3 nos. 2 nos.	-2.251 mPD

For Pumping Station P1-P5

NO.	REVISED	BY	DATE
1	ISSUED	BY	DATE
2	REVISED	BY	DATE
3	REVISED	BY	DATE
4	REVISED	BY	DATE
5	REVISED	BY	DATE
6	REVISED	BY	DATE
7	REVISED	BY	DATE
8	REVISED	BY	DATE
9	REVISED	BY	DATE
10	REVISED	BY	DATE

FOR PUMPING STATION P1-P5

TYPE A SILT SCREEN

(For Pumping Stations P1-P5)

DATE: 11/20/01

SCALE: 1:100

PROJECT: [REDACTED]

CLIENT: [REDACTED]

DESIGNER: [REDACTED]

CHECKER: [REDACTED]

APPROVER: [REDACTED]

DATE: 11/20/01

SCALE: 1:100

PROJECT: [REDACTED]

CLIENT: [REDACTED]

DESIGNER: [REDACTED]

CHECKER: [REDACTED]

APPROVER: [REDACTED]



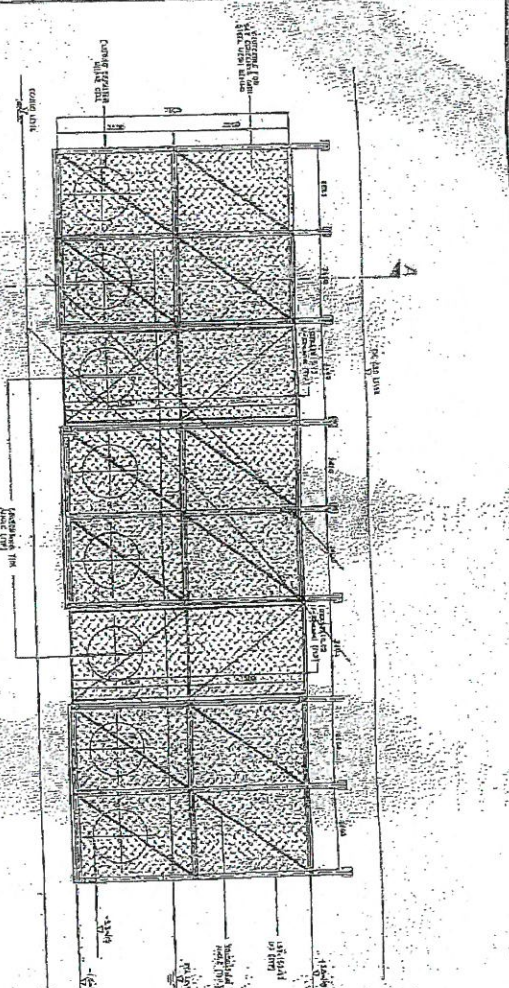

ELEVATION OF TYPICAL DETAIL FOR  
SILT SCREEN OVER INTAKE PIPES  
EXISTING PUMPING STATION OF HIGGS EXTENSION (P-6)  
SCALE 1:100

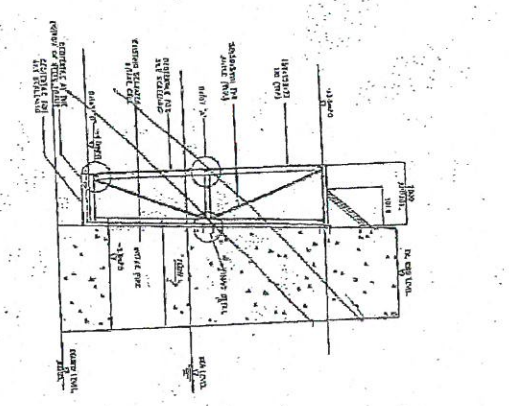

SECTION A-A  
SCALE 1:100

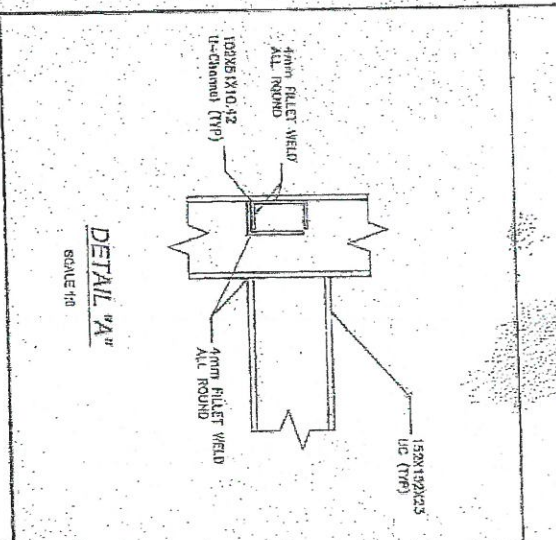

DETAIL "A"  
SCALE 1:10

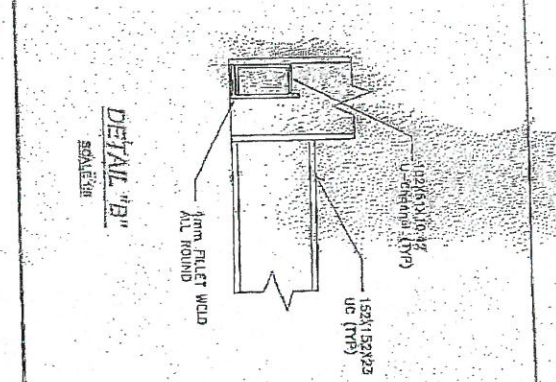

DETAIL "B"  
SCALE 1:10

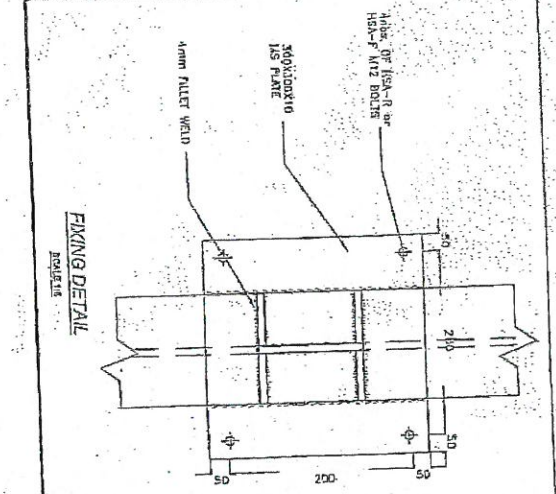

FIXING DETAIL  
SCALE 1:10

- NOTES
1. ALL DIMENSIONS SHALL BE GIVEN IN MM.
  2. ALL CONCRETE SHALL BE FROM FRESH WEIGHT MIX RATIO. CHECK SPECIFIC.
  3. ALL STEEL SHOULD BE VSL-400 EQUIVALENT.

CHUAN CHAI KONG  
INCORPORATED ARCHITECTURAL ENGINEERS & SURVEYORS  
4155 MIDLAND AVENUE SUITE 101 MIDLAND SQUARE  
4375 4TH FLOOR

Prepared by: S. Subramanian

CSF/108 A

REV	DESCRIPTION	DATE
1	ISSUED	10/08/08
2	REVISED	10/08/08
3	REVISED	10/08/08

CHUN WAI - Leader JV  
WAI CHAI DEVELOPMENT PHASE II  
730, 732, 734, 736, 738, 740, 742, 744, 746, 748, 750, 752, 754, 756, 758, 760, 762, 764, 766, 768, 770, 772, 774, 776, 778, 780, 782, 784, 786, 788, 790, 792, 794, 796, 798, 800, 802, 804, 806, 808, 810, 812, 814, 816, 818, 820, 822, 824, 826, 828, 830, 832, 834, 836, 838, 840, 842, 844, 846, 848, 850, 852, 854, 856, 858, 860, 862, 864, 866, 868, 870, 872, 874, 876, 878, 880, 882, 884, 886, 888, 890, 892, 894, 896, 898, 900, 902, 904, 906, 908, 910, 912, 914, 916, 918, 920, 922, 924, 926, 928, 930, 932, 934, 936, 938, 940, 942, 944, 946, 948, 950, 952, 954, 956, 958, 960, 962, 964, 966, 968, 970, 972, 974, 976, 978, 980, 982, 984, 986, 988, 990, 992, 994, 996, 998, 1000

CONCRETE TYPE 1 SILT SCREEN  
FOR PUMPING STATION

HW/2009/01/01/RI-008A  
DATE: 11/08  
CONTRACT ADDRESS

Typo 1

**Appendix C**  
**Type 2 Silt Screen**



**NOTES:**

1. ALL DIMENSIONS ARE TO BE OBTAINED FROM EXISTING DRAWINGS.
2. UNLESS OTHERWISE NOTED, ALL DIMENSIONS ARE IN METERS.
3. UNLESS OTHERWISE NOTED, ALL LEVELS ARE IN METER ABOVE MEAN SEA LEVEL (MAMSL).

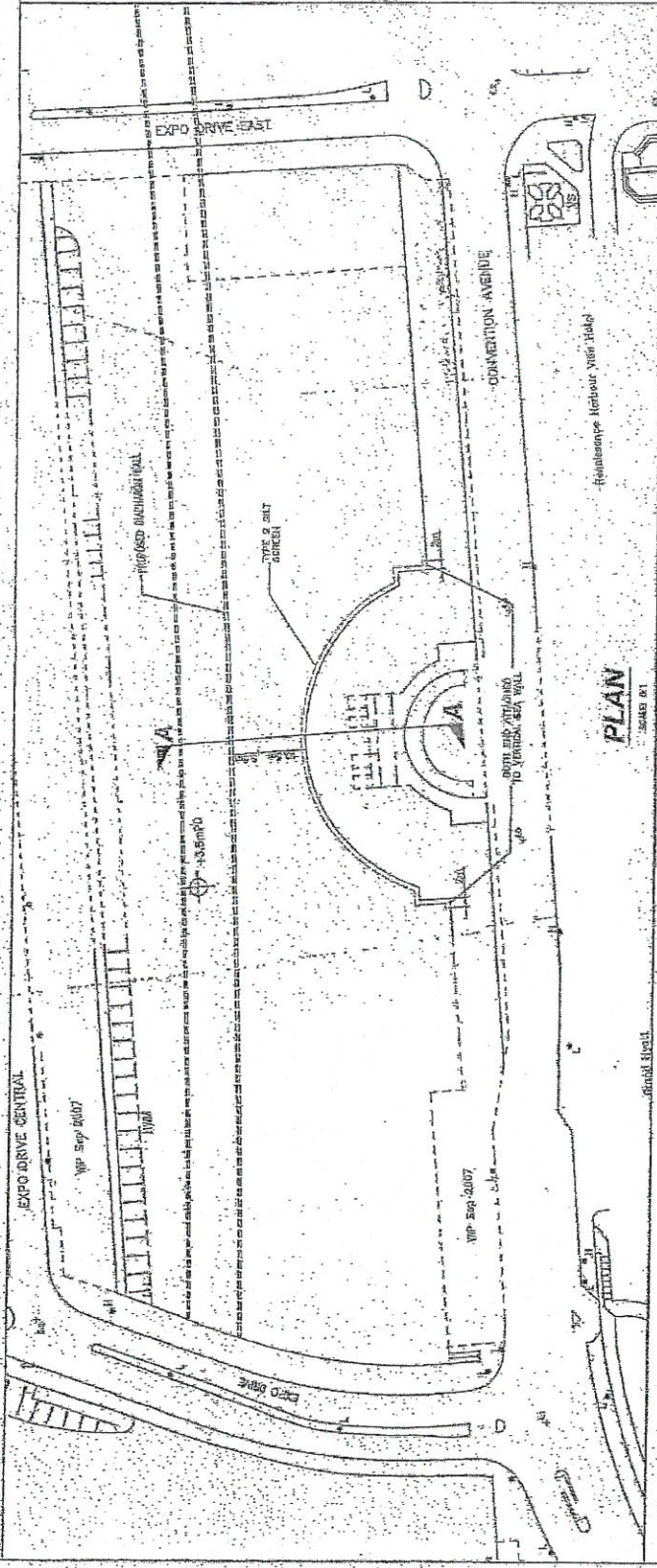

**PLAN**  
SCALE: 1:50

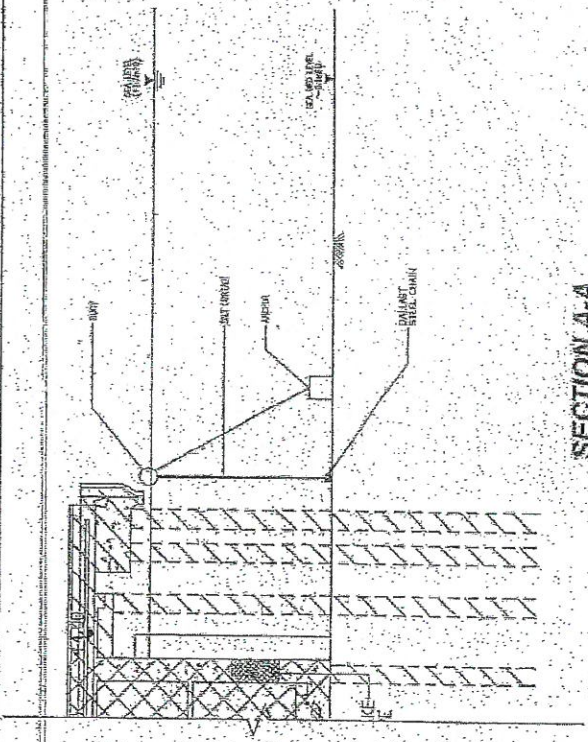

**SECTION A-A**  
SCALE: 1:50

1	REVISED	BY	13-03-07
0	ISSUED FOR PRINT	BY	13-03-07
	DESCRIPTION	BY	DATE

**Chun Wo - Leader JV**

**AECOM**

**WAN CHAI DEVELOPMENT PHASE II**

**TYPE 2 - SLIT SCREEN**

DRAWING NO: **JW/2000/01/DPH-04-05**  
 DATE: **14-03-07**

**Appendix D**  
**Type 3 Silt Screen**





**Appendix E**  
**Specification of Proposed Geotextile for Type 1, 2 and 3 Silt Screens**



# bontec

a better technical fabric product

## SG 100/100

Technical data sheet according to internal specifications Bonar TF version 03 dd. 17/02/03  
 Accompanying documents CE marking: version 01 dd. 01/10/02



1137  
 1137-CPD-601  
 03

separation	filtration	reinforcement	protection	drainage

	test method	value	tolerance
<b>Mechanical properties</b>			
Tensile strength MD	EN ISO 10319	110 kN/m	-9.9 kN/m
Tensile strength CD	EN ISO 10319	110 kN/m	-9.9 kN/m
Elongation MB	EN ISO 10319	20 %	+/- 4.8 %
Elongation CD	EN ISO 10319	14 %	+/- 2.53 %
Static puncture resistance - CBR	EN ISO 12224	12.5 kN	-2.5 kN
Dynamic penetration resistance - cone drop	EN 918	10 mm	+2 mm
<b>Hydraulic properties</b>			
Water permeability normal to the plane	EN ISO 11058	23 x 10 <sup>-3</sup> m/s	- 8.9 x 10 <sup>-3</sup> m/s
Water flow normal to the plane (l <sup>2</sup> )	EN ISO 11058	23 l/m <sup>2</sup> .s	- 8.9 l/m <sup>2</sup> .s
Characteristic opening size	EN ISO 12955	190 µm	+/- 57 µm
<b>Physical properties</b>			
Thickness under 2 kPa (l)	EN 954/1	1.53 mm	+/- 0.33 mm
Weight (l)	EN 955	473 g/m <sup>2</sup>	+/- 47.5 g/m <sup>2</sup>
Composition	100 % polypropylene woven geotextile		

**Durability**

- geotextile has to be covered within 2 weeks after installation
- predicted to be durable for a minimum of 25 years in natural soil with 4 < pH < 9 and soil temperatures < 25 °C.

roads	railways	foundations & retaining walls	drainage systems	erosion control systems
EN 13249:2000	EN 13250:2000	EN 13251:2000	EN 13252:2000	EN 13253:2000
reservoirs & dams	canals	tunnels & underground structures	solid waste	liquid waste
EN 13254:2000	EN 13255:2000	EN 13256:2000	EN 13257:2000	EN 13258:2000

- This geotextile is intended for use in both horizontal & applications highlighted with a bold border.
- Roll dimensions are 6,25 m x 100,00 m. Other dimensions on demand.
- Bonar Technical Fabric reserves the right to alter product specifications without prior notice. It is the responsibility of all users to verify dimensions that they should be required.
- Although not guaranteed, these results do in the best of our knowledge offer a true and accurate record of the product's performance.
- Bonar Technical Fabric cannot accept responsibility for the performance of these products in the conditions of use not beyond our control.
- Not mandated characteristics for CE marking.



BONAR Technical Fabric Italia  
 Via S. Felice 10 - 40019 S. Felice sul Panaro (MO)  
 Tel. +39 059 400000 - Fax +39 059 400001  
 E-mail: info@bonar.it

BONAR Technical Fabric USA  
 2000 S. 1st St. - Houston, TX 77058-1000  
 Tel. +1 281 465 4000 - Fax +1 281 465 4001  
 E-mail: info@bonarusa.com



## Mirafi® X Woven Polypropylene Geotextiles

### Properties of Mirafi X Woven Polypropylene Geotextiles

Property	Unit	500g	550g	580g
<b>Mechanical properties</b>				
<b>Wide width tensile strength</b>				
ISO 10319, ASTM D4595				
Mean ultimate tensile strength	MD kN/m	25	35	50
Mean ultimate tensile strength	CD kN/m	25	35	50
Extension at peak strength	MD %	20	20	20
Extension at peak strength	CD %	20	20	20
<b>Grab tensile strength</b>				
ASTM D4632				
Mean tensile strength	MD kN	1.0	1.2	1.5
Mean tensile strength	CD kN	1.0	1.2	1.5
Extension at peak strength	MD %	15	15	15
Extension at peak strength	CD %	15	15	15
<b>CBR puncture strength</b>				
ISO 12236, ASTM D6241				
Mean puncture strength	kN	4.2	4.2	5.5
<b>UV resistance after 500 hrs</b>				
ASTM D4595				
Strength retention	%	70	70	70
<b>Hydraulic properties</b>				
<b>Apparent opening size – ASTM D4751</b>				
	mm	0.425	0.425	0.425
<b>Water permeability – ASTM D4431</b>				
Mean flow rate	l/m <sup>2</sup> /s	5	5	5
Mean permeability	sv	0.05	0.05	0.2
<b>Roll dimensions</b>				
Nominal roll width	m	4	4	4
Nominal roll length	m	200	200	200
Estimated roll weight	kg	175	180	180

2016-05-03-11161

Mirafi® is a registered trademark of Royal Ten Cate. The information contained herein is to the best of our knowledge accurate, but since the circumstances and conditions in which it may be used are beyond our control we do not accept any liability for any loss or damage, however arising, which results directly or indirectly from use of such information nor does it constitute a warranty or assumption of liability on our part.

Ten Cate Industrial (Malaysia) Co., Ltd.  
 Bukit Mertajam Road 16  
 Harbour Industrial Zone, Zhongyi DISTRICT, Lintan  
 Tel: +6010 635 1574, Fax: +60333 204 7310  
 Email: info.mirafi@tencate.com

Ten Cate Engineering (Malaysia) Sdn. Bhd.  
 14, Jalan Semerak 2/784, Dataran 27,  
 43400 Seri Kembangan, Selangor, Darul Ehsan, Malaysia  
 Tel: +603 892 6555, Fax: +603 892 6572  
 Email: info.mirafi@tencate.com





**Appendix F**  
**Arrange of Access Provision for Water Monitoring**

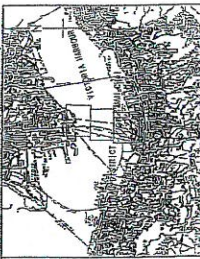

INSET 'A'  
SCALE 1:1000

**KEY PLAN**  
SCALE 1:2000

**NOTES:**

1. FOR SLOES AND LEGEND, REFER TO DRAWING NO. 600041297/C1/100/1103D.
2. SHALL REFER TO DRAWING NO. 600041297/C1/100/1103D.
3. THESE PARTS OF THE SITE INCLUDE THE CONVENTION AND EXHIBITION CENTRE AND THE SILL CURTAIN DEPLOYMENT PLAN. THE SILL CURTAIN DEPLOYMENT PLAN IS LOCATED AT THE BOTTOM LEFT OF THE SHEET, AS SHOWN ON DRAWING NO. 600041297/C1/100/1103D.

JOB NO.	EASTING	NORTHING	DEPTH
01	438242.114	0.65044.534	
02	438242.098	0.65044.533	
03	438242.082	0.65044.532	
04	438242.066	0.65044.531	
05	438242.050	0.65044.530	
06	438242.034	0.65044.529	
07	438242.018	0.65044.528	
08	438242.002	0.65044.527	
09	438241.986	0.65044.526	
10	438241.970	0.65044.525	
11	438241.954	0.65044.524	
12	438241.938	0.65044.523	
13	438241.922	0.65044.522	
14	438241.906	0.65044.521	
15	438241.890	0.65044.520	
16	438241.874	0.65044.519	
17	438241.858	0.65044.518	
18	438241.842	0.65044.517	
19	438241.826	0.65044.516	
20	438241.810	0.65044.515	
21	438241.794	0.65044.514	
22	438241.778	0.65044.513	
23	438241.762	0.65044.512	
24	438241.746	0.65044.511	
25	438241.730	0.65044.510	
26	438241.714	0.65044.509	
27	438241.698	0.65044.508	
28	438241.682	0.65044.507	
29	438241.666	0.65044.506	
30	438241.650	0.65044.505	
31	438241.634	0.65044.504	
32	438241.618	0.65044.503	
33	438241.602	0.65044.502	
34	438241.586	0.65044.501	
35	438241.570	0.65044.500	
36	438241.554	0.65044.499	
37	438241.538	0.65044.498	
38	438241.522	0.65044.497	
39	438241.506	0.65044.496	
40	438241.490	0.65044.495	
41	438241.474	0.65044.494	
42	438241.458	0.65044.493	
43	438241.442	0.65044.492	
44	438241.426	0.65044.491	
45	438241.410	0.65044.490	
46	438241.394	0.65044.489	
47	438241.378	0.65044.488	
48	438241.362	0.65044.487	
49	438241.346	0.65044.486	
50	438241.330	0.65044.485	
51	438241.314	0.65044.484	
52	438241.298	0.65044.483	
53	438241.282	0.65044.482	
54	438241.266	0.65044.481	
55	438241.250	0.65044.480	
56	438241.234	0.65044.479	
57	438241.218	0.65044.478	
58	438241.202	0.65044.477	
59	438241.186	0.65044.476	
60	438241.170	0.65044.475	
61	438241.154	0.65044.474	
62	438241.138	0.65044.473	
63	438241.122	0.65044.472	
64	438241.106	0.65044.471	
65	438241.090	0.65044.470	
66	438241.074	0.65044.469	
67	438241.058	0.65044.468	
68	438241.042	0.65044.467	
69	438241.026	0.65044.466	
70	438241.010	0.65044.465	
71	438240.994	0.65044.464	
72	438240.978	0.65044.463	
73	438240.962	0.65044.462	
74	438240.946	0.65044.461	
75	438240.930	0.65044.460	
76	438240.914	0.65044.459	
77	438240.898	0.65044.458	
78	438240.882	0.65044.457	
79	438240.866	0.65044.456	
80	438240.850	0.65044.455	
81	438240.834	0.65044.454	
82	438240.818	0.65044.453	
83	438240.802	0.65044.452	
84	438240.786	0.65044.451	
85	438240.770	0.65044.450	
86	438240.754	0.65044.449	
87	438240.738	0.65044.448	
88	438240.722	0.65044.447	
89	438240.706	0.65044.446	
90	438240.690	0.65044.445	
91	438240.674	0.65044.444	
92	438240.658	0.65044.443	
93	438240.642	0.65044.442	
94	438240.626	0.65044.441	
95	438240.610	0.65044.440	
96	438240.594	0.65044.439	
97	438240.578	0.65044.438	
98	438240.562	0.65044.437	
99	438240.546	0.65044.436	
100	438240.530	0.65044.435	

CUT LINE B-B  
SEE AS BOUNDING BY: 600019745/100/1103

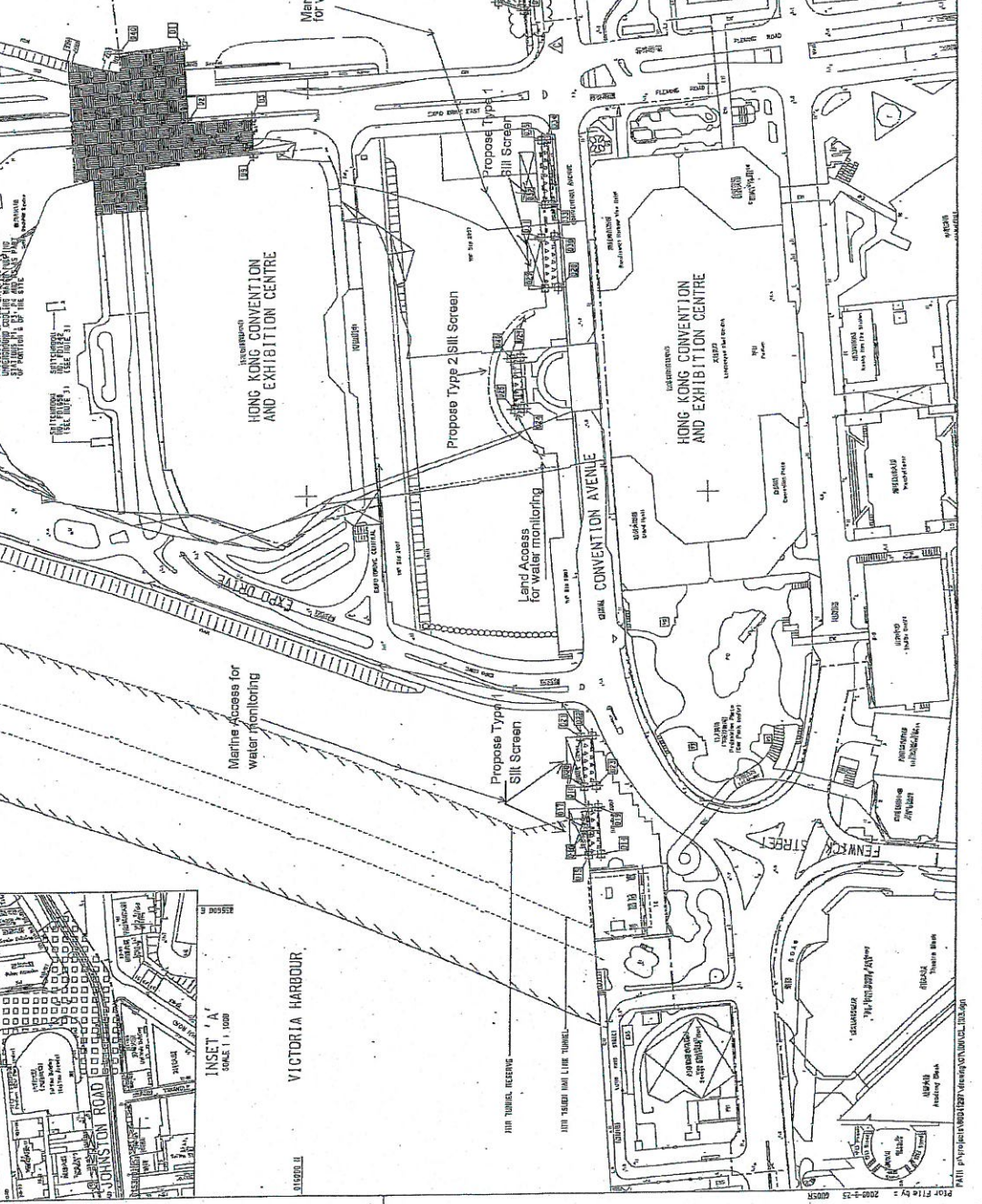
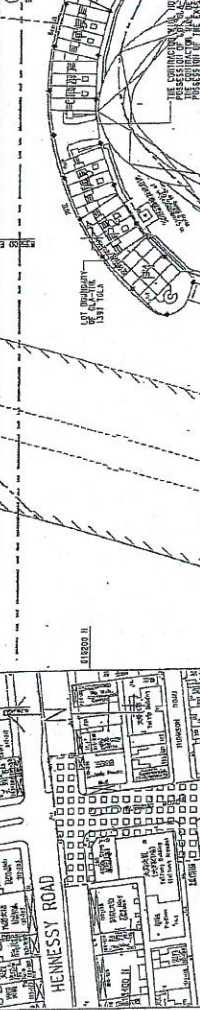

WORKING DRAWING	DATE: 2000-03-25
REVISED DRAWING	
REVISION	
NO.	DESCRIPTION
A	REVISION AMENDMENT NO. 1
B	REVISION AMENDMENT NO. 2
C	REVISION AMENDMENT NO. 3
D	REVISION AMENDMENT NO. 4
E	REVISION AMENDMENT NO. 5
F	REVISION AMENDMENT NO. 6
G	REVISION AMENDMENT NO. 7
H	REVISION AMENDMENT NO. 8
I	REVISION AMENDMENT NO. 9
J	REVISION AMENDMENT NO. 10
K	REVISION AMENDMENT NO. 11
L	REVISION AMENDMENT NO. 12
M	REVISION AMENDMENT NO. 13
N	REVISION AMENDMENT NO. 14
O	REVISION AMENDMENT NO. 15
P	REVISION AMENDMENT NO. 16
Q	REVISION AMENDMENT NO. 17
R	REVISION AMENDMENT NO. 18
S	REVISION AMENDMENT NO. 19
T	REVISION AMENDMENT NO. 20

**WIN O'HAI DEVELOPMENT PHASE II**  
 CIVIL ENGINEERING AND  
 DEVELOPMENT DEPARTMENT  
 PROJECT NO. 600041297/C1/100/1103D  
 WORKING DRAWING NO. 600041297/C1/100/1103D  
 SHEET 3 OF 3

**AECOM**

PROJECT NO. 600041297/C1/100/1103D

WORKING DRAWING

SHEET 3 OF 3



**Appendix G**  
**Silt Screen Inspection Checklist**



Contract No. HK/2009/01  
 Wan Chai Development Phase II - Central -  
 Wan Chai Bypass at Hong Kong Convention and Exhibition Centre

Client: Civil Engineering and Development Department  
 Consultant: AECOM  
 Main Contractor: Chun Wo - Leader Joint Venture

**Silt Screen / Silt Curtain Daily Inspection Checklist**

Silt Screen / Silt Curtain ID: \_\_\_\_\_  
 Location: \_\_\_\_\_  
 Inspection Date and Time: \_\_\_\_\_

Item	Description	Condition		Immediate Action Required? *		Target Rectify Date	Remark
		Yes	No	Yes	No		
1	Any floating debris/refuse within silt curtain?						
2	Supporting frame / buoys in good condition?						
3	Tying wire / rope in good condition?						
4	Geotextile intact and in good condition						
5	Sinkers in good condition?						
6	Any obstruction to water flow between geotextile?						

Checked by: \_\_\_\_\_ Endorsed by: \_\_\_\_\_  
 On behalf of Chun Wo-Leader JV On behalf of AECOM

\*Note: For silt screen / silt curtain with defects which need to be rectified immediately, related marine work has to be stopped until rectification work completed to the satisfaction of the Engineer.

**Appendix H**  
**Programme for the Installation and Removal of the Silt Screens**

Contract No. HK/2009/01

Wan Chai Development Phase II - Central Wan Chai Bypass - Central - Wan Chai Bypass at HKCEC Working Programme for The Installation and Removal of the Silt Screens at Wan Chan & TST

Activity Description	Start	Finish	2010				2011				2012				2013				2014				2015				2016				
			Q1	Q2	Q3	Q4	Q1	Q2	Q3	Q4	Q1	Q2	Q3	Q4	Q1	Q2	Q3	Q4	Q1	Q2	Q3	Q4	Q1	Q2	Q3	Q4	Q1	Q2	Q3	Q4	
Installation of Silt Screens before relocation of Wan Chai Pump Station C1, C2, C3, C4E, C4W	29/4/10	29/6/10																													
Installation of Silt Screens for Seawater Intakes WSD7, WSD19	19/7/10	30/9/10																													
Installation of Silt Screens at TST	29/8/11	13/10/11																													
Installation of Silt Screens after relocation of Wan Chai Pump Station P1, P3, P4, P5	10/11/12	27/12/12																													
Maintenance of Silt Screens before relocation of Wan Chai Pump Station C1, C2, C3, C4E, C4W	29/4/10	30/11/13																													
Maintenance of Silt Screens for Seawater Intakes WSD7, WSD19	19/7/10	31/8/15																													
Maintenance of Silt Screens at TST	29/8/11	30/11/13																													
Maintenance of Silt Screen after relocation of Wan Chai Pump Station C1, P1, P3, P4, P5	10/11/12	31/8/15																													
Removal of Silt Screens at TST	1/7/13	30/11/13																													
Removal of Silt Screens before relocation of Wan Chai Pump Station C2, C3, C4E, C4W	1/7/13	30/11/13																													
Removal of Silt Screens after relocation of Wan Chai Pump Station C1, P1, P3, P4, P5	31/8/15	30/9/15																													
Removal of Silt Screens for Seawater Intakes WSD7, WSD19	31/8/15	30/9/15																													

Last Updated on: 31-August-2015

Remark: P1, P3, P4, P5, C1, C2, C4E & C4W are the monitoring stations



**Appendix I**  
**Communication Records**



AECOM  
PRE Office  
9 Performing Arts Avenue  
Admiralty  
Hong Kong  
www.aecom.com

+852 2587 1778 tel  
+852 2587 1877 fax

Your Ref :  
Our Ref : WDII(GEN)/M30/300/WB00346

22 September 2014

To Distribution:

Dear Sirs/Madam,

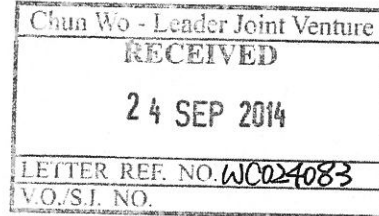

**Environmental Impact Assessment (EIA) Ordinance, Cap. 499.  
Wan Chai Development Phase II and Central-Wan Chai Bypass  
(Environmental Permits EP-356/2009, EP-364/2009/C, EP-376/2009 and EP-416/2011)**

**Notes of Environmental Project Committee (ENPC) Meeting No. 51 on 15 August 2014**

I enclose herewith a copy of the notes of the captioned meeting for your retention and action, if necessary.

A copy of meeting agenda for ENPC meeting No. 52, which is scheduled on 16 October 2014 (Thursday), is attached for your information.

Yours faithfully,  
For and on behalf of  
Environmental Project Committee

SO Chi Fung, Perseus  
Secretary

Encl.

SWC/PS/YT/sy  
*su*

Your Ref :

Our Ref : WDII/(GEN)/M30/300/WB00346

**Distribution List:**

P.1

<b>Company / Address</b>	<b>Contact Person</b>
1. Civil Engineering and Development Department Hong Kong Island and Islands Development Office Hong Kong Island Division 2 13th Floor, North Point Govt Offices 333 Java Road, North Point, H.K.	Attn: Mr. Jason CHEUNG
2. Highways Department Major Works Project Management Office Major Work Office (2) 3/F, Ho Man Tin Government Offices 88 Chung Hau Street Ho Man Tin, Kowloon	Attn: Mr. Eddy WU
3. Highways Department Railway Development Office Railway Development Division 1-2 U/F, Ho Man Tin Government Offices 88 Chung Hau Street Ho Man Tin, Kowloon	Attn: Mr. David CHAN, E/SCL 6
4. AECOM Asia Co. Ltd. (WDII's Team) 8/F Grand Central Plaza Tower 2 138 Shatin Rural Committee Road Shatin, New Territories	Attn: Mr. Stephen LAI
5. AECOM Asia Co. Ltd. (CWB's Team) 8/F Grand Central Plaza Tower 2 138 Shatin Rural Committee Road Shatin, New Territories	Attn: Mr. Alex LI
6. AECOM Asia Co. Ltd. (WDII/RSS) PRE's Office 9 Performing Arts Avenue Admiralty, Hong Kong	Attn: Mr. Frankie FAN
7. AECOM Asia Co. Ltd. (CWB/RSS) 25 Hung Hing Road Causeway Bay, Hong Kong	Attn: Mr. Peter POON
8. AECOM Asia Co. Ltd. (CWB's Team) 11/F, Block C, Sea View Estate 2-8 Watson Road North Point, Hong Kong	Attn: Mr. S. K. LO

.../Cont'd

Your Ref :

Our Ref : WDII/(GEN)/M30/300/WB00346

P.2

<b>Company / Address</b>	<b>Contact Person</b>
9. ENVIRON Hong Kong Limited (IEC) Room 2403 Jubilee Centre 18 Fenwick Street Wan Chai, Hong Kong	Attn: Mr. David YEUNG
10. Lam Geotechnics Ltd. (ET) 11/F, Centre Point 181-185 Gloucester Road Wan Chai, Hong Kong	Attn: Mr. Raymond DAI
11. MTR Corporation Limited 8/F., Fo Tan Railway House No. 9 Lok King Street Fo Tan New Territories Hong Kong	Attn: Mr. Richard KWAN
12. Chun Wo – Leader Joint Venture 5C, Hong Kong Spinners Industrial Building, Phase I 601-603 Tai Nan West Street Cheung Sha Wan, Kowloon	Attn: Mr. Simon LIU
13. Chun Wo – China Railway Group Limited Joint Venture 5C, Hong Kong Spinners Industrial Building, Phase I 601-603 Tai Nan West Street Cheung Sha Wan, Kowloon	Attn: Mr. K. K. YUEN
14. Leighton Contractor (Asia) Ltd. 39/F, Sun Hung Kai Centre 30 Harbour Road Wan Chai, Hong Kong	Attn: Mr. Desmond SZE
15. China State Construction Engineering (Hong Kong) Ltd. 29/F, China Overseas Building 139 Hennessy Road Wan Chai, Hong Kong	Attn: Mr. Gene CHEUNG
16. China State – Leader Joint Venture 29/F, China Overseas Building 139 Hennessy Road Wan Chai, Hong Kong	Attn: Mr. Andrew TSE
17. China State Construction Engineering (Hong Kong) Ltd. 29/F, China Overseas Building 139 Hennessy Road Wan Chai, Hong Kong	Attn: Mr. Dave CHAN

.../Cont'd



Your Ref :

Our Ref : WDII/(GEN)/M30/300/WB00346

P.3

Company / Address	Contact Person
18. Gammon – Leader Joint Venture 28/F Devon House TaiKoo Place 979 King's Road Hong Kong	Attn: Mr. Eric YIP
19. Chun Wo – CRGL – MBEC Joint Venture Room 2803-2804 28/F Citicorp Centre 18 Whitfield Road Hong Kong	Attn: Mr. Paul YU
20. Leighton Joint Venture 39/F, Sun Hung Kai Centre 30 Harbour Road Wan Chai, Hong Kong	Attn: Mr. Colman WONG
21. Environmental Protection Department Environmental Assessment Division Metro Assessment Group Hong Kong Island Section (3) 28th Floor, Southorn Centre 130 Hennessy Road Wan Chai, Hong Kong	Attn: Mr. Billy MA
22. Environmental Protection Department Environmental Compliance Division Regional Office (South) Wanchai 3rd Floor, Chinachem Exchange Square 1 Hoi Wan Street Quarry Bay Hong Kong	Attn: Dr. K. K. LAU / Mr. Sean LAW / Mr. Allan LEE

**Wan Chai Development Phase II and Central – Wan Chai Bypass Projects**

**Environmental Project Committee (ENPC) Meeting No. 51**

**Notes of Meeting**

---

**Meeting Date / Time:** 15 August 2014 (Friday), 9:30a.m. – 10:00a.m

**Venue:** Central Community Liaison Centre, Man Yiu Street, Central, Hong Kong

---

**Subject:** Environmental Project Committee (ENPC) Meeting No. 51

**PRESENT:**

Mr. Jason CHEUNG, SE(Chairman)	} CEDD (HKI&Is Dev. Office)
Mr. Jackel TANG, E	}
Mr. Sunny TAN, E	} AECOM/WDII Consultant
Mr. Perseus SO, RE (Secretary)	} WDII/RSS (AECOM)
Mr. Ken LEUNG, ARE	}
Mr. Yam TENG, ARE	}
Mr. Paul YE, ARE	}
Ms. Queenie TSANG, CEG	}
Mr. C. F. NG, GEG	}
Mr. Eric WONG, SRE	} CWB/RSS (AECOM)
Mr. Jacky CHOI, RE	}
Mr. Alex LYN, RE	}
Mr. Jason KWAN, ARE	}
Mr. David YEUNG, IEC	} ENVIRON Hong Kong Ltd.
Mr. Raymond DAI, ET Leader	} Lam Geotechnics Ltd.
Mr. Alan LI, ET Representative	}
Mr. Terry WONG, Construction Manager	} Chun Wo – Leader Joint Venture
Ms. Wendy NG, Env. Officer	} (HK/2009/01)
Mr. C. P. HO, Q&E Manager	} CW-CRGL JV (HK/2009/02)
Mr. Keith TSE, Deputy Site Agent	} China State Construction Engineering
Ms. Jacqueline YIP, Senior Engineer	} (Hong Kong) Ltd. – Leader JV (HK/2012/08, CS-L JV))
Mr. Andy MAK, Env. Officer	} China State Construction Engineering
Ms. Esther CHOI, Env. Supervisor	} (Hong Kong) Ltd. (HY/2009/15, CSHK T1)
Mr. C.M. WONG, Env. Officer	} China State Construction Engineering
	} (Hong Kong) Ltd. (HY/2010/08, CSHK T2)
Mr. Tom TING, Env. Supervisor	} CW-CRGL-MBEC JV (HY/2009/19)
Mr. Ivan WONG, Section Agent	}
Mr. Chris MAK, Env. Engineer II	} MTR Corporation Limited
Mr. David HUNG, Env. Engineer	} Leighton Contractors (Asia) Limited
	} (HY/2009/18)
Mr. Penny YIU, Env. Supervisor	} Leighton JV (HY/2011/08)

**ABSENT WITH APOLOGY:**

Mr. Eddy WU, SE	} Highways Department (HyD/MWPMO)
Mr. P. C. LEUNG, E	}
Mr. Clement PANG, Env. Officer	} Gammon-Leader JV (HK/2010/06)
Mr. James MA, Env. Officer	} China State Construction Engineering (Hong Kong) Ltd. – Leader JV (HK/2012/08, CS-L JV))



<u>No.</u>	<u>ITEM</u>	<u>ACTION</u>
	<b>(1) Confirmation of the notes of the last meeting</b>	
1.	The notes of the last meeting were confirmed as a true record.	Noted
	<b>(2) Matter arising from the last meeting</b>	
2.	Nil	Noted
	<b>(3) Actions under the Master Environmental Permits (EP-356/2009, EP-364/2009/C, EP-376/2009 and EP-416/2011)</b>	
	<b>(a) Follow-up action regarding Environmental Protection Department (EPD)'s comments on the updated Environmental Monitoring &amp; Audit (EM&amp;A) Manual and water / air / noise baseline monitoring reports.</b>	
3.	ET Leader reported that the Monthly EM&A Reports (June 2014) of EP-356/2009, EP-364/2009/B, EP-416/2011 for EPD had been submitted on 15 July 2014, whereas the Monthly EM&A Reports (July 2014) of EP-356/2009, EP-364/2009/C, EP-416/2011 for EPD had been submitted on 15 August 2014, and the Quarterly EM&A Reports (March to May 2014) of EP-356/2009, EP-364/2009/B, EP-416/2011 for EPD had been submitted on 27 June, 27 June and 26 June 2014 respectively.	Noted
4.	ET Leader reported that EPD advised update of EM&A manual for EP-356/2009 should address only major changes of current EM&A scheme. The summary of major changes was under review with IEC; EPD advised that there was no need to update the EM&A manual for EP-364/2009/C as no major change in the work scope.	Noted
	<b>(b) Impact monitoring works</b>	
	<b>(i) Air Quality Monitoring Stations</b>	
5.	ET Leader stated that regular air quality monitoring continued at 8 monitoring stations in the reporting period, all of them were currently reported under the statutory EM&A programme. No exceedance was recorded.	Noted
	<b>(ii) Noise Monitoring Stations</b>	
6.	ET Leader reported that regular noise monitoring exercises continued at 9 stations in the reporting period. 6 no. of exceedances of noise level were recorded at monitoring stations M2b, M6 and M7w in June 2014 and no exceedances of noise level were recorded in July 2014. 4 no. of the exceedances at M6 were found mainly due to traffic noise and therefore not project related. 1 exceedance at M2b was concluded to be project-related. Remedial mitigation measures were taken and no exceedance was identified in the subsequent monitoring. 1 exceedance at M7w was also concluded as project related. ET Leader reported that the concerned concrete breaking work of the Contractor site compound was completed and no more exceedance was identified.	Noted

<u>No.</u>	<u>ITEM</u>	<u>ACTION</u>
	(iii) Real-time Noise Monitoring Stations	
7.	ET Leader reported that real-time noise monitoring continued at 4 stations in the reporting period. ET Leader advised that no project related exceedance was recorded.	Noted
	(iv) Water Quality Monitoring Stations	
8.	ET Leader reported that water quality monitoring was carried out at 10 locations in the reporting period.	Noted
9.	ET Leader reported that 2 nos. (Action Level) of DO exceedances were recorded in June 2014 and no DO exceedances were recorded in July 2014. ET Leader reported that the exceedances were due to natural variation around the intake locations and concluded that the exceedances were not project related.	Noted
10.	ET Leader reported that no turbidity exceedances were recorded in June and July 2014.	Noted
11.	ET Leader reported that no SS exceedances were recorded in June and July 2014.	Noted
12.	ET Leader reported 12 nos. (Limit Level) of DO exceedances were recorded in June 2014 whilst 8 nos. (Limit Level) of DO exceedances were recorded in July 2014 for enhanced water quality at CBTS and Ex-Cargo handling area in the reporting period. After investigation, ET concluded that these exceedances were due to occasional upstream discharge of organic particles from Culvert O and low tide condition, and therefore not project related.	Noted
13.	ET Leader reported that Odour Patrol was conducted on 8 and 22 July 2014 respectively and no exceedances were recorded whilst no Odour Patrol was conducted in June 2014.	Noted
14.	ET Leader advised that all silt screens were found in order during the reporting period.	Noted
	<b>(4) Actions under the Further Environmental Permits (FEPs)</b>	
	<b>(a) FEP-02/356/2009 &amp; FEP-02/364/2009 (Permit holder: The Contractor of CEDD's Contract No. HK/2009/01 - Wan Chai Development Phase II – Central – Wan Chai Bypass at Hong Kong Convention and Exhibition)</b>	
15.	ET Leader advised that no further comments from ET/IEC on the Silt Screen Deployment Plan (Rev. 6) under FEP-02/356/2009 were given to the Contractor. The Plan would be submitted to EPD shortly by the Contractor.	CW-L JV

<u>No.</u>	<u>ITEM</u>	<u>ACTION</u>
16.	ET Leader advised that comments from ET/IEC on the Landscape Plan (Rev. 2) under FEP-02/364/2009 were given to the Contractor. The Plan was under revision by the Contractor.  <b>(b) FEP-03/356/2009 &amp; FEP-01/364/2009 (Permit holder: The Contractor of CEDD's Contract No. HK/2009/02 - Wan Chai Development Phase II – Central – Wan Chai Bypass at Wan Chai East)</b>	CW-L JV
17.	ET Leader advised that comments from EPD/ PlanD on the Landscape Plan (Rev. B) under FEP-01/364/2009 were given to the Contractor. The Plan was under revision by the Contractor.	CW-CRGL-JV
18.	No outstanding submission for FEP-03/356/2009.  <b>(c) FEP-04/356/2009, FEP-06/364/2009/A and FEP-01/416/2011 (Permit holder: The Contractor of HyD's Contract No. HY/2009/15 - Central - Wan Chai Bypass - Tunnel - Causeway Bay Typhoon shelter section)</b>	Noted
19.	ET Leader advised that the Landscape Plan (Rev. 2) under FEP-06/364/2009/A was submitted to EPD on 19 May 2014. Comments from EPD were given to the Contractor on 11 June 2014. The Plan was under revision by the Contractor.	CSHK T1
20.	No outstanding submission for FEP-04/356/2009 or FEP-01/416/2011.  <b>(d) FEP-05/364/2009/A (Permit holder: The Contractor of HyD's Contract No. HY/2009/18 - Central - Wan Chai Bypass - Central Interchange)</b>	Noted
21.	No outstanding submission for FEP-05/364/2009/A.  <b>(e) FEP-07/364/2009/A (Permit holder: The Contractor of HyD's Contract No. HY/2009/19 - Central - Wanchai Bypass Tunnel (North Point Section) and Island Eastern Corridor Link)</b>	Noted
22.	ET Leader reported that EPD's further comments on Noise Management Plan (Rev. 4) under FEP-07/364/2009/A were given to the Contractor on 17 July 2014. The revised Plan was under advance review by EPD.  <b>(f) FEP-05/356/2009 and FEP-08/364/2009/A (Permit holder: The Contractor of CEDD/s Contract No. HK/2010/06 Wan Chai Development Phase II – Central-Wan Chai Bypass over MTR Tsuen Wan Line)</b>	CW-CRGL-MBEC JV
23.	ET Leader reminded that the Contractor should prepare surrender applications for FEP-05/356/2009 and FEP-08/364/2009/A in due course.  <b>(g) FEP-06/356/2009 and FEP-09/364/2009/B (Permit holder: The Contractor of CEDD's Contract No. HK/2012/08 – Wan Chai Development Phase II – Central – Wan Chai Bypass at Wan Chai West)</b>	GLJV



<u>No.</u>	<u>ITEM</u>	<u>ACTION</u>
24.	ET Leader reported that the Landscape Plan (Rev. 2) under FEP-09/364/2009/B was submitted to EPD on 27 June 2014.	CS-L JV
25.	No outstanding submission for FEP-06/356/2009.	Noted
	<b>(h) FEP-07/356/2009 and FEP-10/364/2009/B (Permit holder: The Contractor of HyD's Contract No. HY/2010/08 – Central - Wan Chai Bypass - Tunnel – Slip Road 8 Section)</b>	
26.	ET Leader advised that further comments from EPD on the Landscape Plan (Rev. 2) under FEP-10/364/2009/B were given to the Contractor. The Plan was under revision by the Contractor.	CSHK T2
27.	ET Leader advised that comments from EPD on the Additional Mitigation Plan (Rev. 1) were given to the Contractor on 8 August 2014. The Plan was under revision by the Contractor.	CSHK T2
28.	ET Leader advised that the Landscape Plan (Rev. 3) under FEP-07/356/2009 was submitted to EPD on 5 August 2014.	CSHK T2
29.	ET Leader advised that comments from ET/IEC on the Silt Screen Deployment Plan (Rev. 2) under FEP-07/356/2009 were given to the Contractor on 29 May 2014. The Plan was under revision by the Contractor.	CSHK T2
30.	ET Leader advised that no further comments from ET/IEC on the Silt Curtain Deployment Plan (Rev. 2) under FEP-07/356/2009 were given to the Contractor. The Plan would be submitted to EPD shortly by the Contractor.	CSHK T2
	<b>(i) FEP-11/364/2009/B (Permit holder: The Contractor of HyD's Contract No. HY/2011/08 – Central - Wan Chai Bypass - Tunnel Buildings, Systems and Fittings and Works Associated with Tunnel Commissioning)</b>	
31.	ET Leader advised that comments from EPD on the Landscape Plan (Rev. 1) were given to the Contractor on 8 August 2014. The Plan was under revision by the Contractor.	LJV
32.	ET Leader advised that comments from EPD on the Noise Management Plan (Rev. 1) were given to the Contractor on 8 August 2014. The Plan was under revision by the Contractor.	LJV
33.	ET Leader advised that comments from ET/IEC on the Operational Air Quality Management Plan (Rev. 1) were given to the Contractor. The Plan was under revision by the Contractor.	LJV
	<b>(5) Report of specific environmental matters, including mitigation measures, follow-up action, recommendation etc. arising from the works contracts under the Project</b>	
	<b>(a) Contract No. HY/2009/15</b>	

<u>No.</u>	<u>ITEM</u>	<u>ACTION</u>
34.	ET Leader reminded that the Contractor of HY/2009/15 should closely monitor the condition and sufficiency of silt curtain for temporary reclamation removal works.  (b) Contract No. HY/2009/18	Noted
35.	No particular discussion.  (c) Contract No. HY/2009/19	Noted
36.	ET Leader reminded the Contractor of Contract No. HY/2009/19 to provide noise mitigation measures in accordance with EP condition 2.9.  (d) Contract No. HK/2009/01	Noted
37.	ET Leader reminded that the Contractor of Contract No. HK/2009/01 should regularly monitor the condition of silt curtain for filling works at Expo Drive East.  (e) Contract No. HK/2009/02	Noted
38.	ET Leader reminded that the Contractor of Contract No. HK/2009/02 to provide mitigation measures for large scale stockpiling.  (f) Contract No. HK/2010/06	Noted
39.	No particular discussion.  (g) Contract No. HK/2012/08	Noted
40.	LAM reminded that the Contractor of HK/2012/08 should regularly clean the grease/scum trapped within temporary water channel at HKCEC2W.  (h) Contract No. HY/2010/08	Noted
41.	ET Leader reminded that the Contractor of HY/2010/08 shall maintain the temporary site drainage.  (6) Cumulative environmental impacts arising from the works contracts for the construction of WDII and CWB Projects	Noted
42.	ET Leader advised that the active dredging works in the reporting period were all within the allowed dredging rate and the Contractors should note the cumulative effect of multiple CNPs at restricted hour to avoid cumulative noise impact.	Noted
43.	With respect to the completion of dredging of Type 3 disposal of Category H sediments under HK/2009/01 since October 2012; and the completion of dredging works for both Cross Harbour Water Mains and submarine sewage outfall since March 2012 and November 2011 respectively, ET Leader advised that the remaining dredging activities would be under Scenario 2C so that the application of silt screen and the water quality monitoring stations would be reviewed with IEC accordingly.	Noted

<u>No.</u>	<u>ITEM</u>	<u>ACTION</u>
	<b>(7) Report on environmental related complaints and follow-up actions</b>	
44.	ET Leader reported that 4 complaints were received from EPD and ICC in the reporting period.	Noted
45.	For the complaint (EPD Case Ref. No. EP860/E2/24), ET Leader reported that the complaint was concerned about the muddy dispersion observed at the waterfronts outside HK Academy of Performing Arts Theater Blocks on 12 June 2014. ET reported that the preliminary report was issued on 16 June 2014 and the interim report was submitted to EPD on 20 June 2014. EPD advised no further comments and the complaint case was closed on 17 July 2014.	Noted
46.	For the complaint (EPD Case Ref. No. H04/RS/00013590-14), ET Leader reported that the complaint was concerned about the excessive paint spray odour occurred at foot-bridge to Central Pier 7 on 23 June 2014. ET reported that the preliminary report was issued on 25 June 2014 and the interim report was submitted to EPD on 30 June 2014. EPD advised no further comment on the interim report submitted and the complaint case was closed on 21 July 2014.	Noted
47.	For the complaint (ICC Case Ref. No: 2-341537112), ET Leader reported that the complaint was concerned about noise nuisance due to works and machine at project site opposite to Ngan Tao Building during night time on 21 July 2014. Investigation report was submitted to EPD on 31 July 2014. Further concern was raised by complaint referred by RSS on 31 July 2014. Further Investigation Report was issued on 12 August 2014.	Noted
48.	For the complaint (ICC Case Ref. No: 2-360638977), ET Leader reported that the complaint was concerned about noise nuisance caused by sand and gravel stockpile movement at construction site opposite to Harbour Heights during nighttime on 31 July 2014. Preliminary report was issued on 5 August 2014 and the final investigation report was issued on 12 August 2014.	Noted
	<b>(8) Report on the setting up of Community Liaison Group (CLG) and related matters</b>	
	<b>(a) North Point CLG meeting</b>	
49.	CWB/RSS advised that regular liaison meetings were held with various stakeholders in the reporting period. No particular environmental concern was raised from the stakeholders. The next CLG Meeting was scheduled to be held on 13 November 2014.	Noted
	<b>(b) Wan Chai CLG meeting</b>	
50.	WDII/RSS advised that meetings were held with various stakeholders including cooling mains operators and Hong Kong Convention and Exhibition Centre in the reporting period. No particular environmental issues were raised in the meetings. [Attachment A]	Noted



<u>No.</u>	<u>ITEM</u>	<u>ACTION</u>
	<b>(c) Central CLG meeting</b>	
51.	CWB/RSS advised that regular liaison meetings were held with various stakeholders in the reporting period. No particular environmental concern was raised from the stakeholders. The next CLG meeting was scheduled to be held on 6 October 2014.	Noted
	<b>(d) Causeway Bay CLG meeting</b>	
52.	CWB/RSS advised that the CLG meeting was held on 19 June 2014. No particular environmental concern was raised from the stakeholders. The next CLG meeting was scheduled to be held on 4 December 2014.	Noted
	<b>(9) Any Other Business</b>	
53.	ET Leader reported that Variation of Environmental Permit application for Ngau Kok Wan storage condition was approved by EPD on 11 July 2014 as EP-364/2009/C.	Noted
54.	All Contractors are reminded that for all interface/work transition areas, upon handed over of the area and surrender of FEP by the existing Contractor, the relevant conditions under the EP would be transferred to the subsequent Contractor correspondingly.	All to Note
	<b>(10) Next meeting</b>	
55.	The next ENPC meeting (No. 52) was scheduled at 9:30 a.m. on 16 October 2014 (Thursday) at the Community Liaison Centre, Man Yiu Street, Central, Hong Kong.	Noted

ENPC Meeting Schedule in 2014

Date	Chair by
16 December 2014 (Tuesday)	CEDD

Prepared by:  
Perseus SO  
RE/WDII  
Date: 5 September 2014

- END -

## Wan Chai Development Phase II

**Meetings with Wan Chai Community Liaison Group (CLG) members in other communication Channel (From 17 June 2014 to the date of the ENPC Meeting No. 51)**

Date	Meeting / Activities
<b>a) Cooling Mains Operators (Private)</b>	
10 July 2014	Monthly Progress Meeting on re-provisioning of Sea Water Cooling Facilities with representatives of all CLG members under the sub-group of Cooling Mains Operators (Private).
14 August 2014	
<b>b) Hong Kong Convention and Exhibition Centre (HKCEC)</b>	
18 June 2014	Meeting with HKCEC for discussion on proposed temporary traffic arrangements (TTAs) to be implemented in the vicinity of HKCEC and associated environmental mitigation measures.
24 July 2014	
12 August 2014	
<b>c) Hotels (Grand Hyatt Hotel, Renaissance Harbour View Hotel, Harbour View International House)</b>	
	Nil
<b>d) Others (Consultation of CLG members under sub-group is conducted when as-needed)</b>	
	Nil









AECOM  
 PRE Office  
 9 Performing Arts Avenue  
 Admiralty  
 Hong Kong  
 www.aecom.com

+852 2587 1778 tel  
 +852 2587 1877 fax

Your Ref :  
 Our Ref : WDII(GEN)/M30/300/WB00419

23 September 2015

To Distribution:

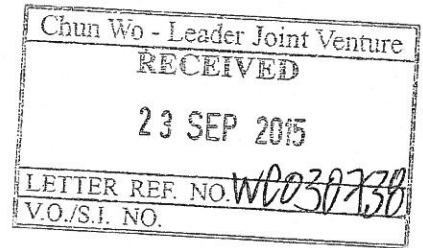

Dear Sirs/Madam,

**Environmental Impact Assessment (EIA) Ordinance, Cap. 499.  
 Wan Chai Development Phase II and Central-Wan Chai Bypass  
 (Environmental Permits EP-356/2009, EP-364/2009/C, EP-376/2009 and EP-416/2011)**

**Notes of Environmental Project Committee (ENPC) Meeting No. 57 on 17 August 2015**

I enclose herewith a copy of the notes of the captioned meeting for your retention and action, if necessary.

A copy of meeting agenda for ENPC meeting No. 58, which is scheduled on 15 October 2015 (Thursday), is attached for your information.

Yours faithfully,  
 For and on behalf of  
 Environmental Project Committee

SO Chi Fung, Perseus  
 Secretary

Encl.

PS/EL/JS/tyl

Chun Wo - Leader Joint Venture				
Job No - CL0907				
Contract No. HK/2009/01				
Date:				
Position	Action	Info	Initial	
JV Representative				
Site Agent				W
Deputy Site Agent				
Commercial Mgr				
Engineering Mgr				
Planning Eng				
CM - Marine / NHWM				
CM - Tunnel				
CM - Waterworks				
Safety Dept				
Environmental Officer	✓			
QA/QC				
Managing CS				
Chief Surveyor				
Admin Officer				
HR Dept				
CLO				



Your Ref :

Our Ref : WDII(GEN)/M30/300/WB00419

P. 2

Company / Address	Contact Person
9. RAMBOLL ENVIRON Hong Kong Limited (IEC) Room 2403 Jubilee Centre 18 Fenwick Street Wan Chai, Hong Kong	Attn: Mr. David YEUNG
10. Lam Geotechnics Ltd. (ET) 11/F, Centre Point 181-185 Gloucester Road Wan Chai, Hong Kong	Attn: Mr. Raymond DAI
11. MTR Corporation Limited 8/F., Fo Tan Railway House No. 9 Lok King Street Fo Tan, New Territories Hong Kong	Attn: Mr. Richard KWAN
12. Chun Wo – Leader Joint Venture 5C, Hong Kong Spinners Industrial Building, Phase I 601-603 Tai Nan West Street Cheung Sha Wan, Kowloon	Attn: Mr. Andy YU
13. Chun Wo – China Railway Group Limited Joint Venture 5C, Hong Kong Spinners Industrial Building, Phase I 601-603 Tai Nan West Street Cheung Sha Wan, Kowloon	Attn: Mr. K. K. YUEN
14. Leighton Contractor (Asia) Ltd. 39/F, Sun Hung Kai Centre 30 Harbour Road Wan Chai, Hong Kong	Attn: Mr. Jimmy CHU
15. China State Construction Engineering (Hong Kong) Ltd. 29/F, China Overseas Building 139 Hennessy Road Wan Chai, Hong Kong	Attn: Mr. Andrew WONG
16. China State – Leader Joint Venture 29/F, China Overseas Building 139 Hennessy Road Wan Chai, Hong Kong	Attn: Mr. Keith TSE
17. China State Construction Engineering (Hong Kong) Ltd. 29/F, China Overseas Building 139 Hennessy Road Wan Chai, Hong Kong	Attn: Mr. Dave CHAN

...Cont'd





**Wan Chai Development Phase II and Central – Wan Chai Bypass Projects**

**Environmental Project Committee (ENPC) Meeting No. 57**

**Notes of Meeting**

---

**Meeting Date / Time:** 17 August 2015 (Monday), 9:30a.m. – 10:25a.m

**Venue:** Central Community Liaison Centre, Man Yiu Street, Central, Hong Kong

---

**Subject:** Environmental Project Committee (ENPC) Meeting No. 57

**PRESENT:** Mr. Stephen LO, SE (Chairman) } CEDD (HKI&Is Dev. Office)  
Mr. Jackel TANG, E }

Ms. Grace FOK, E } Highways Department (HyD/MWPMO)

Mr. Sunny TAN, E } AECOM/WDII Consultant

Mr. Perseus SO, SRE (Secretary) } WDII/RSS (AECOM)  
Mr. Eliot LIU, RE }  
Ms. Shirley CHENG, RE }  
Mr. Will TSANG, RE }  
Mr. K. H. NG, ARE }  
Mr. Henry LI, ARE }  
Mr. Kanji YIP, ARE }  
Mr. Jack SHUEN, ARE }  
Mr. Kevin WONG, ARE }

Mr. Eric WONG, SRE } CWB/RSS (AECOM)  
Ms. Christy CHUNG, RE }  
Mr. Jason KWAN, ARE }

Mr. F C. TSANG, IEC Representative } RAMBOLL ENVIRON Hong Kong Ltd.

Mr. Raymond DAI, ET Leader } Lam Geotechnics Ltd.  
Mr. Alan LI, ET Representative }

Mr. Terry WONG, Construction Manager } Chun Wo – Leader Joint Venture  
Ms. Wendy NG, Env. Officer } (HK/2009/01, CW-L JV)

Mr. C. P. HO, Env. Officer } CW-CRGL JV (HK/2009/02)

Mr. Keith TSE, Site Agent } China State Construction Engineering  
Mr. James MA, Env. Officer } (Hong Kong) Ltd. – Leader JV  
(HK/2012/08, CS-L JV)

Mr. Andrew WONG, Project Manager } China State Construction Engineering  
Mr. S. H. LAM, Env. Supervisor } (Hong Kong) Ltd. (HY/2009/15, CSHK T1)

Mr. Gabriel WONG, Env. Officer } China State Construction Engineering  
Mr. Desmond HO, Env. Supervisor } (Hong Kong) Ltd. (HY/2010/08, CSHK T2)

Mr. Tony LEUNG, Assistant Section Agent } CW-CRGL-MBEC JV (HY/2009/19)  
Mr. M.H. ISA, Env. Officer } (CCMJV)

**PRESENT:** Ms. Christy SO, Env. Supervisor

} Leighton Contractors (Asia) Limited  
(HY/2009/18)

Mr. Malcolm LEUNG, Env Officer

} Leighton JV (HY/2011/08)

**ABSENT WITH APOLOGY:**

Mr. Chris MAK, Env. Engineer II

} MTR Corporation Limited

<u>No.</u>	<u>ITEM</u>	<u>ACTION</u>
	<b>(1) Confirmation of the notes of the last meeting</b>	
1.	The notes of the last meeting with the following amendments were confirmed as a true record:- <ul style="list-style-type: none"> <li>• Item No. 3, the Monthly EM&amp;A Reports (April 2015) of EP-356/2009, EP-364/2009/C and EP-416/2011 for EPD were submitted on 15 May 2015 instead of 16 May 2015.</li> <li>• Item No. 4, the summary of changes for the EM&amp;A manual for EP-356/2009 was submitted to EPD on 15 May 2015 instead of 28 April 2015.</li> </ul>	Noted
	<b>(2) Matter arising from the last meeting</b>	
2.	Nil	Noted
	<b>(3) Actions under the Master Environmental Permits (EP-356/2009, EP-364/2009/C, EP-376/2009 and EP-416/2011)</b>	
	<b>(a) Follow-up action regarding Environmental Protection Department (EPD)'s comments on the updated Environmental Monitoring &amp; Audit (EM&amp;A) Manual and water / air / noise baseline monitoring reports.</b>	
3.	ET Leader reported that the Monthly EM&A Reports (June 2015) of EP-356/2009, EP-364/2009/C, EP-376/2009 and EP-416/2011 for EPD had been submitted on 15 July 2015, whereas the Monthly EM&A Reports (July 2015) of EP-356/2009, EP-364/2009/C, EP-376/2009 and EP-416/2011 for EPD had been submitted on 14 August 2015. The Quarterly EM&A Report (May to July 2015) of EP-376/2009 for EPD would be submitted on 31 August 2015.	Noted
4.	ET Leader reported that the summary of changes for the EM&A manual for EP-356/2009 was submitted to EPD on 15 May 2015 and EPD advised no comment on the submitted summary on 29 May 2015. The updated summary on monitoring stations division with respect to Contracts commenced in 2014 for the EM&A manual for EP-364/2009/C had been reviewed with IEC and the updating of EM&A manual would be further discussed with EPD. The revised baseline monitoring report incorporating EPD's comments for EP-376/2009 was submitted to EPD on 12 June 2015 and EPD advised no comment on 3 July 2015.	Noted
5.	ET Leader reported that the proposal of EM&A programme termination for EP-416/2011 was submitted to EPD on 15 July 2015. EPD advised on 5 August 2015 that a Final EM&A Review Report shall be submitted prior to proposing termination of EM&A programme while the EM&A programme shall be maintained prior to formal approval of proposed termination. The Final EM&A Review Report was under IEC review to verify before submission.	Noted
	(Post meeting note: The Final EM&A Review Report was found in order by EPD on 8 September 2015. The proposal for termination of EM&A programme was submitted to EPD on 4 September 2015.)	



<u>No.</u>	<u>ITEM</u>	<u>ACTION</u>
	<b>(b) Impact monitoring works</b>	
	(i) Air Quality Monitoring Stations	
6.	ET Leader stated that regular air quality monitoring continued at 8 monitoring stations in the reporting period, all of them were currently reported under the statutory EM&A programme. No project related exceedance was recorded.	Noted
	(ii) Noise Monitoring Stations	
7.	ET Leader reported that regular noise monitoring exercises continued at 9 stations in the reporting period. 3 nos. of exceedance of noise level were recorded on 5, 9 and 16 June 2015 but were found to be not project related which were due to IEC traffic.	Noted
	(iii) Real-time Noise Monitoring Stations	
8.	ET Leader reported that real-time noise monitoring continued at 4 stations in the reporting period. ET Leader advised that no project related exceedance was recorded.	Noted
	(iv) Water Quality Monitoring Stations	
9.	ET Leader reported that water quality monitoring was carried out at 8 locations in the reporting period.	Noted
10.	ET Leader reported that no DO exceedance was recorded in June and July 2015.	Noted
11.	ET Leader reported that 1 no. (Limit Level) of turbidity exceedance was recorded in both June and July 2015. ET Leader reported that the exceedances were due to natural variation in water quality around monitoring station. ET Leader concluded that the exceedance was not project related.	Noted
12.	ET Leader reported that 1 no. (Limit Level) of SS exceedance was recorded in June 2015 at station C7 and no SS exceedance was recorded in July 2015. ET Leader reported that there was no marine works undertaken by HY/2010/08 contractor and the exceedance was concluded as non-project related.	Noted
13.	ET Leader reported 2 nos. (Action Level) and 3 nos. (Limit Level) of DO exceedance were recorded in June 2015, whereas 4 nos. (Limit Level) of DO exceedances were recorded in July 2015 for enhanced DO monitoring at CBTS and Ex-Cargo handling area in the reporting period. After investigation, ET reported that no marine work was undertaken during monitoring and concluded that the exceedances were due to contribution of organics from nearby culvert discharge and low tide condition, and therefore not project related.	Noted



<u>No.</u>	<u>ITEM</u>	<u>ACTION</u>
14.	ET Leader further reported that low DO level (<2mg/L) were observed on both 4 and 20 July 2015 during flood tide. No dredging works was conducted on the monitoring date and the DO level was restored on each subsequent monitoring event.	Noted
15.	ET Leader reported that the enhanced DO monitoring at monitoring station Ex-PCWA-SE was resumed on finely adjusted location on 10 August 2015.	Noted
16.	ET Leader reported that the Odour Patrol was conducted on 7 and 21 July 2015 along the shorelines of Causeway Bay Typhoon Shelter and ex-Wan Chai Public Cargo Working Area in this reporting period. No exceedance was recorded. The Odour Patrol would continue to be carried out in bi-weekly intervals in August and September 2015.	Noted
17.	ET Leader advised that all silt screens were found in order during the reporting period. It was recorded that silt screens P1, P3 and P4 were found damaged on 15 July 2015 and pending for Contractor's remedial action.	CW-L JV
	<b>(4) Actions under the Further Environmental Permits (FEPs)</b>	
	<b>(a) FEP-02/356/2009 &amp; FEP-02/364/2009 (Permit holder: The Contractor of CEDD's Contract No. HK/2009/01 - Wan Chai Development Phase II – Central – Wan Chai Bypass at Hong Kong Convention and Exhibition)</b>	
18.	ET Leader advised that comments by EPD on the Landscape Plan (Rev. 4) under FEP-02/364/2009 were given to the Contractor on 5 August 2015. The Plan was under revision by the Contractor for resubmission.	CW-L JV
19.	ET Leader advised that ET/IEC further commented Silt Screen Deployment Plan (Rev.8) under FEP-02/356/2009 on 15 August 2015. The Plan was under revision by the Contractor for resubmission.	CW-L JV
	<b>(b) FEP-03/356/2009 &amp; FEP-01/364/2009 (Permit holder: The Contractor of CEDD's Contract No. HK/2009/02 - Wan Chai Development Phase II – Central – Wan Chai Bypass at Wan Chai East)</b>	
20.	ET Leader advised that comments by ET/IEC on the Landscape Plan (Rev. B) under FEP-01/364/2009 were given to the Contractor on 13 June 2015. The plan was under revision by the Contractor for resubmission.	CW-CRGL-JV
21.	No outstanding submission for FEP-03/356/2009.	Noted
	<b>(c) FEP-04/356/2009, FEP-06/364/2009/A and FEP-01/416/2011 (Permit holder: The Contractor of HyD's Contract No. HY/2009/15 - Central - Wan Chai Bypass - Tunnel - Causeway Bay Typhoon shelter section)</b>	

<u>No.</u>	<u>ITEM</u>	<u>ACTION</u>
22.	ET Leader reported that the FEP surrender application was submitted to EPD on 26 June 2015. A letter was issued by EPD to MTRC on 3 August 2015 for acknowledgement of FEP-01/416/2011 surrender application.	Noted
23.	No outstanding submission for FEP-04/356/2009 or FEP-06/364/2009/A.	Noted
	<b>(d) FEP-05/364/2009/A (Permit holder: The Contractor of HyD's Contract No. HY/2009/18 - Central - Wan Chai Bypass - Central Interchange)</b>	
24.	No outstanding submission for FEP-05/364/2009/A.	Noted
	<b>(e) FEP-07/364/2009/A (Permit holder: The Contractor of HyD's Contract No. HY/2009/19 - Central - Wanchai Bypass Tunnel (North Point Section) and Island Eastern Corridor Link)</b>	
25.	ET Leader reported that the Noise Management Plan (Rev. 4) under FEP-07/364/2009/A was pending for VEP consideration of EPD. CCMJV stated that the revised Environmental Assessment Report for VEP application would be submitted to HyD for review on 18 August 2015 prior to submission to EPD.  (Post-meeting note: A draft VEP application (Form 5) and the revised environmental assessment were sent to EPD for comment on 25 August 2015.)	CCMJV
26.	ET Leader reported that the Landscape Plan (Rev.3) under FEP-07/364/2009/A was further commented by ET/IEC on 15 August 2015. The Plan was under revision by the Contractor for resubmission.	CCMJV
	<b>(f) FEP-06/356/2009, FEP-09/364/2009/B and FEP-01/376/2009 (Permit holder: The Contractor of CEDD's Contract No. HK/2012/08 – Wan Chai Development Phase II – Central – Wan Chai Bypass at Wan Chai West)</b>	
27.	ET Leader advised that the Notification of Commencement of Construction under FEP-01/376/2009 was submitted to EPD on 13 April 2015.	Noted
28.	ET Leader advised that the Noise Management Plan (Rev.1) under FEP-01/376/2009 was submitted to EPD on 24 July 2015. The Plan was under review by EPD.	Noted
29.	ET Leader advised that the Landscape Plan (Rev.0) under FEP-01/376/2009 was found in order by EPD on 5 August 2015.	Noted
30.	ET Leader advised that the Landscape Plan (Rev. 3) under FEP-09/364/2009/B was submitted to EPD on 24 July 2015. The Plan was under review by EPD.	Noted

<u>No.</u>	<u>ITEM</u>	<u>ACTION</u>
31.	No outstanding submission for FEP-06/356/2009.	Noted
	<b>(g) FEP-07/356/2009 and FEP-10/364/2009/B (Permit holder: The Contractor of HyD's Contract No. HY/2010/08 – Central - Wan Chai Bypass - Tunnel – Slip Road 8 Section)</b>	
32.	ET Leader advised that comments by ET/IEC on the Landscape Plan (Rev. 3) under FEP-10/364/2009/B were given to the Contractor on 1 June 2015. CSHK T2 stated that the updated Landscape Plan would be resubmitted by 28 August 2015.	CSHK T2
	<b>(h) FEP-11/364/2009/B (Permit holder: The Contractor of HyD's Contract No. HY/2011/08 – Central - Wan Chai Bypass - Tunnel Buildings, Systems and Fittings and Works Associated with Tunnel Commissioning)</b>	
33.	ET Leader advised that the Landscape Plan (Rev. 2) under FEP-11/364/2009/B was found in order by EPD on 13 July 2015.	Noted
34.	ET Leader advised that the Noise Management Plan (Rev. 2) under FEP-11/364/2009/B was commented by EPD on 5 August 2015. The Plan was under revision by the Contractor for resubmission.	LJV
35.	ET Leader advised that EPD had no further comment on the Operational Air Quality Management Plan for West Ventilation Building (Rev. 1) under FEP-11/364/2009/B on 23 April 2015.	Noted
36.	ET Leader advised that comments by EPD on the Operational Air Quality Management Plan for East Ventilation Building (EVB) and Ventilation System of Eastern Portal for CWB Tunnel (Electrostatic Precipitator System) under FEP-11/364/2009/B were given to the Contractor on 23 April 2015. LJV stated that the updated Plan would be submitted within 2 months.	LJV
	<b>(5) Report of specific environmental matters, including mitigation measures, follow-up action, recommendation etc. arising from the works contracts under the Project</b>	
	<b>(a) Contract No. HY/2009/15</b>	
37.	ET Leader reminded the Contractor of HY/2009/15 to collect refuse regularly near site exit of the storage at Siu Ho Wan.	Noted
	<b>(b) Contract No. HY/2009/18</b>	
38.	ET Leader reminded the Contractor of HY/2009/18 to cover the stockpiled material.	Noted

<u>No.</u>	<u>ITEM</u>	<u>ACTION</u>
	<b>(c) Contract No. HY/2009/19</b>	
39.	ET Leader reminded the Contractor of HY/2009/19 to provide temporary noise barrier for IEC W/B removal works, in particular during saw cutting works. ET Leader further reminded the Contractor of HY/2009/19 to carry out grass cutting within the maintained area at Siu Ho Wan.	Noted
	<b>(d) Contract No. HK/2009/01</b>	
40.	ET Leader reminded the Contractor of HK/2009/01 to provide mitigation measure for marine sediment handling.	Noted
	<b>(e) Contract No. HK/2009/02</b>	
41.	ET Leader reminded the Contractor of HK/2009/02 to arrange silt curtain for upcoming WCR3 filling works.	Noted
	<b>(f) Contract No. HK/2012/08</b>	
42.	ET Leader reminded the Contractor of HK/2012/08 to maintain silt curtain at the temporary water channel and collect piling effluent to avoid surface runoff impact. ET Leader further reminded the Contractor of HK/2012/08 to provide proper wheel washing for Expo Drive.	Noted
	<b>(g) Contract No. HY/2010/08</b>	
43.	ET Leader reminded the Contractor of HY/2010/08 to install site hoarding adjacent to Victoria Park children's playground. ET Leader reminded the Contractor of HY/2010/08 to provide drip tray for the oil drums at the storage area at Ngau Kwok Wan.	Noted
	<b>(f) Contract No. HY/2011/08</b>	
44.	No particular discussion.	Noted
	<b>(6) Cumulative environmental impacts arising from the works contracts for the construction of WDII and CWB Projects</b>	
45.	ET Leader advised that the active dredging works in the reporting period were all within the allowed dredging rate and the Contractors should note the cumulative effect of multiple CNPs at restricted hour to avoid cumulative noise impact.	Noted
46.	With respect to the completion of dredging works for WCR3 and HKCEC2 since July 2015 and August 2014 respectively, ET Leader advised that the application of silt screen and the water quality monitoring stations would be reviewed with IEC accordingly.	Noted



<u>No.</u>	<u>ITEM</u>	<u>ACTION</u>
	<b>(7) Report on environmental related complaints and follow-up actions</b>	
47.	ET Leader reported that 4 new complaints were received from EPD and ICC in the reporting period.	Noted
48.	For the previous complaint (EPD Case Ref. No. H05/RS/00013254-15), ET Leader reported that the complaint was concerned about no wheel washing being provided to vehicle leaving construction site and dust nuisance around gate V2 and V3 near Expo Drive Central on 29 May 2015. ET Leader reported that the interim investigation report was submitted to EPD on 16 June 2015. EPD advised no comment on 20 July 2015 and case closed.	Noted
49.	For the previous complaint (EPD Case Ref. No. H05/RS/00013843-15), ET Leader reported that the complaint was concerned about the construction noise generated from the construction site during restricted hours on 4 June 2015. ET Leader reported that the interim investigation report was submitted to EPD on 16 June 2015. EPD advised no comment on 20 July 2015 and case closed.	Noted
50.	For the complaint (EPD Case Ref. No. H05/RS/00015054-15), ET Leader reported that the complaint was concerned about dark smoke and malodour emission was observed from a hopper barge moored near shore and other construction plants under operation from the reclamation construction site on 18 June 2015. ET Leader reported that the interim investigation report was submitted to EPD on 29 June 2015. EPD advised no comment on 20 July 2015 and case closed.	Noted
51.	For the complaint (EPD Case Ref. No. H05/RS/00016215-15), ET Leader reported that the complaint was concerned about dark smoke was observed from a derrick barge in yellow color for reclamation on 30 June 2015. ET Leader reported that the interim investigation report was submitted to EPD on 10 July 2015. EPD advised no comment on 6 August 2015 and case closed.	Noted
52.	For the complaint (ICC Case Ref. No. #2-1149562777), ET Leader reported that the complaint was concerned about muddy effluent directly discharged into nearby waters on 11 July 2015. ET Leader reported that the investigation result indicated the muddy discharged was originated from other WSD construction works area at the concerned location and the final investigation report was issued on 24 July 2015.	Noted
53.	For the complaint (EPD Case Ref. No. H04/RS/00018040), ET Leader reported that the complaint was concerned about malodour from marine sediment on 20 July 2015. ET Leader reported that the interim investigation report was submitted to EPD on 30 July 2015. EPD advised no comment on 17 August 2015 and case closed.	Noted

<u>No.</u>	<u>ITEM</u>	<u>ACTION</u>
	<b>(8) Report on the setting up of Community Liaison Group (CLG) and related matters</b>	
	<b>(a) North Point CLG meeting</b>	
54.	CWB/RSS advised that the CLG meeting was held with various stakeholders. No particular environmental concern was raised from the stakeholders. The next CLG meeting was scheduled to be held on 17 November 2015.	Noted
	<b>(b) Wan Chai CLG meeting</b>	
55.	WDII/RSS advised that meetings were held with various stakeholders including cooling mains operators and Hong Kong Convention and Exhibition Centre in the reporting period. No particular environmental issues were raised in the meetings. [Attachment A]	Noted
	<b>(c) Central CLG meeting</b>	
56.	CWB/RSS advised that regular liaison meetings were held with various stakeholders in the reporting period. No particular environmental concern was raised from the stakeholders. The next CLG meeting was scheduled to be held on 7 September 2015.	Noted
	<b>(d) Causeway Bay CLG meeting</b>	
57.	CWB/RSS advised that regular liaison meetings were held with various stakeholders in the reporting period. No particular environmental concern was raised from the stakeholders. The next CLG meeting was scheduled to be held on 27 November 2015.	Noted
	<b>(9) Any Other Business</b>	
58.	All Contractors are reminded that for all interface/work transition areas, upon handed over of the area and surrender of FEP by the existing Contractor, the relevant conditions under the EP would be transferred to the subsequent Contractor correspondingly.	All to Note
59.	ET Leader advised that the retained trees under WDII-CWB Project would be potentially affected owing to increasing landscape interface with MTR-SCL Contracts at Contract HK/2009/01, HK/2009/02, HK/2012/08 and possibly HY/2009/15. ET Leader advised the Contractors of HK/2009/01 and HK/2009/02 to document the affected trees in the bi-monthly tree progress reports upon submission of updated landscape plans. ET Leader advised MTRC Contractor to provide relevant information in response to the letters issued by the Contractor of HK/2009/01 on 27 May 2015 and by the Contractor of HK/2009/02 on 6 August 2015 respectively. [Attachment B]	All to Note

<u>No.</u>	<u>ITEM</u>	<u>ACTION</u>
(10)	Next meeting	
60.	The next ENPC meeting (No. 58) was scheduled at 9:30 a.m. on 15 October 2015 (Thursday) at the Community Liaison Centre, Man Yiu Street, Central, Hong Kong.	Noted

ENPC Meeting Schedule in 2015

Date	Chaired by
15 December 2015 (Tuesday)	CEDD

Prepared by:  
 Perseus SO  
 SRE/WDII  
 Date: 14 September 2015

- END -





**Meetings with Wan Chai Community Liaison Group (CLG) members in other communication Channel (From 15 June 2015 to the date of the ENPC Meeting No. 57)**

Date	Meeting / Activities
<b>a) Cooling Mains Operators (Private)</b>	
18 June 2015	Monthly Progress Meeting on re-provisioning of Sea Water Cooling Facilities with representatives of all CLG members under the sub-group of Cooling Mains Operators (Private).
30 July 2015	
<b>b) Hong Kong Convention and Exhibition Centre (HKCEC)</b>	
22 June 2015	Meeting with HKCEC for discussion on proposed temporary traffic arrangements (TTAs) to be implemented in the vicinity of HKCEC and associated environmental mitigation measures.
20 July 2015	
<b>c) Hotels (Grand Hyatt Hotel, Renaissance Harbour View Hotel, Harbour View International House)</b>	
	Nil
<b>d) Others (Consultation of CLG members under sub-group is conducted when as-needed)</b>	
	Nil



Landscape interface under WDII-CWB Project with MTR-SCL

Affected trees and locations	Date And Description	Relevant Contract	Actions to be taken	Status
TA1123, TA1159 to TA1168 (Harbour Road and Tonnochy Road)	ET informed by WDII RSS on 15 December 2014.  Affected trees identified to be felled under SCL Project	HK/2009/02	Affected trees to be documented in the bi-monthly tree progress report upon submission of updated landscape plan. (Contractor of HK/2009/02)	Pending Landscape Plan update by Contractor
(Tree group located at construction area opposite to HKAPA)	Affected area was noted handover to SCL Project during weekly env. inspection in February 2015.	HK/2012/08	Listed of area and trees handover to SCL Project shall be updated in corresponding Landscape Plan under EP-364/2009 (Contractor of HK/2012/08)	Updated Landscape plan submitted to EPD, EPD further commented and pending for Contractor revision
T504	ET informed by WDII RSS on 13 May 2015.  Affected tree roots was found damaged by SCL Contractor	HK/2009/01	Affected trees to be documented in the bi-monthly tree progress report upon submission of updated landscape plan. (Contractor of HK/2009/01)	Pending Landscape Plan update by Contractor
T319 to T321, T400, T423 to T425, A160, A162 and A163	ET informed by RSS on 29 May 2015.  Affected trees were tagged by SCL Project Contractor as felled	HK/2009/01	MTRC Contractor to provide relevant information in response to Contractor HK/2009/01 letter issued on 27 May 2015 (MTRC SCL)  (Contractor of HK/2009/01)	Pending SCL Contractor reply  Updated Landscape plan submitted to EPD, EPD further commented and pending for Contractor revision
T0293, T0294, T0296, TA1057 and TA1058  (Harbour Road and Tonnochy Road)	ET informed by WDII RSS on 6 August 2015.  Tagged as "remove" by the Leighton- China State Joint Venture	HK/2009/02	Affected trees to be documented in the bi-monthly tree progress report upon submission of updated landscape plan.  (Contractor of HK/2009/02)	Pending Landscape Plan update by Contractor
T0293, T0294, T0296, TA1057 and TA1058  (Convention Avenue)	ET informed by WDII RSS on 6 August 2015.  Retained trees under HK/2009/02 was found felled. (Area currently possessed by MTRC SCL Project)	HK/2009/02	Affected trees to be documented in the bi-monthly tree progress report upon submission of updated landscape plan. (Contractor of HK/2009/02)	Pending Landscape Plan update by Contractor





## Wan Chai Development Phase II and Central –Wan Chai Bypass Projects

### Environmental Project Committee (ENPC) Meeting No. 58

#### AGENDA

**Date & Time** : 15 October 2015 (Thursday), 9:30 a.m.  
**Venue** : Central-Wan Chai Bypass and Island Eastern Corridor Link Community Liaison Centre, Man Yiu Street, Central, Hong Kong

1. Confirmation of the notes of the last meeting
2. Matters arising from the last meeting
3. Actions under Master Environmental Permits (EP-356/2009, EP-364/2009/C, EP-376/2009, EP-416/2011)

#### Impact monitoring works

- (i) Air Quality Monitoring
- (ii) Noise Monitoring
- (iii) Real-time Noise Monitoring
- (iv) Water Quality Monitoring (including enhanced water quality monitoring at south-western corner of CBTS)

4. Actions under Further Environmental Permits (FEPs)

FEP No.	Permit Holder
(a) FEP-02/356/2009 & FEP-02/364/2009	The Contractor of CEDD's Contract No. HK/2009/01
(b) FEP-03/356/2009 & FEP-01/364/2009	The Contractor of CEDD's Contract No. HK/2009/02
(c) FEP-04/356/2009, FEP-06/364/2009/A & FEP-01/416/2011	The Contractor of HyD's Contract No. HY/2009/15
(d) FEP-05/364/2009/A	The Contractor of HyD's Contract No. HY/2009/18
(e) FEP-07/364/2009/A	The Contractor of HyD's Contract No. HY/2009/19
(f) FEP-06/356/2009, FEP-09/364/2009/B & FEP-01/376/2009	The Contractor of CEDD's Contract No. HK/2012/08
(g) FEP-07/356/2009, FEP-10/364/2009/B	The Contractor of HyD's Contract No. HY/2010/08
(h) FEP-11/364/2009/B	The Contractor of HyD's Contract No. HY/2011/08

5. Report of specific environmental matters, includes mitigation measures, follow-up actions, recommendations etc. arising from the works contracts under the Project
  - a. Contract No. HY/2009/15
  - b. Contract No. HY/2009/18
  - c. Contract No. HY/2009/19
  - d. Contract No. HK/2009/01
  - e. Contract No. HK/2009/02
  - f. Contract No. HK/2012/08
  - g. Contract No. HY/2010/08
  - h. Contract No. HY/2011/08
6. Cumulative environmental impacts arising from the works contracts for the construction of the WDII and CWB Projects
7. Report on environmental related complaints and follow-up actions
8. Report on the setting up of Community Liaison Group (CLG) and related matters
  - a. Report on the North Point CLG meeting
  - b. Report on the Wan Chai CLG meeting
  - c. Report on the Central CLG meeting
  - d. Report on the Causeway Bay CLG meeting

9. Any Other Business

10. Next Meeting: Date and Time: 15 December 2015 (Tuesday)  
Venue: Central Community Liaison Centre





AECOM  
PRE Office  
9 Performing Arts Avenue  
Admiralty  
Hong Kong  
www.aecom.com

+852 2587 1778 tel  
+852 2587 1877 fax

Your Ref :  
Our Ref : WDII/(GEN)/M30/610/WB00408

14 August 2015

To Distribution:

Dear Sirs,

**SA2 to Agreement No. CE 54/2001(CE)  
Wan Chai Development Phase II – Design and Construction for Trunk Road Tunnel Option**

**Notes of Progress Meeting No. 60 on Re-provisioning of Sea Water Cooling Facilities**

Please find enclosed for your information the notes of Progress Meeting No. 60 on Re-provisioning of Sea Water Cooling Facilities held on 30 July 2015.

Yours faithfully,

Gloria Tang  
Chief Resident Engineer  
AECOM Asia Co. Ltd.

Encl. (w/CD)

c.c. AACL - Attn: Mr. Francis Leong (w/o CD)  
AACL - Attn: Mr. Stephen Lai (w/o CD)

FF/GT/MC/KCM/PW/SN/TNK/EL/NKH/KW/PY/oyw

Your Ref :

Our Ref : WDII/(GEN)/M30/610/WB00408

**Distribution List**

Designated Owners	Address and Contact Telephone Number	Contact Person	Existing Pumping Station Location	Enclosure
Colin Chan Consulting Engineers Ltd	Flat C, 18/F Nathan Tower 518-520 Nathan Road, Kowloon	Mr. Colin Chan  Tel: 9811 7902/ 2782 1329  Fax: 2554 9229	—	Notes of Meeting No. 60 of Contract No. HK/2009/02 only & Notes of Meeting No. 60 between Building Owners, CEDD & AACL
Sun Hung Kai Centre & Harbour Centre  (Managed by SHK Real Estate Management Co., Ltd.)	Room 2605-2623 26/F., Sun Hung Kai Centre 30 Harbour Road Wan Chai Hong Kong	Mr. M. C. Choi  Tel: 2828 7845  Mr. Ricky Kwan  Tel: 2828 5218	No. 8-10 near East Bridge & Near Existing WSD Pumping Station	Notes of Meeting No. 60 & Notes of Meeting No. 60 between Building Owners, CEDD & AACL
Shui On Centre	Room 102, 1/F Shui On Centre 6-8 Harbour Road Hong Kong	Ms. Eva Wong  Tel: 2879 1803	No. 3 and 4 Pump Room near West Bridge	Notes of Meeting No. 60 & Notes of Meeting No. 60 between Building Owners, CEDD & AACL
The Hong Kong Academy for Performing Arts	1 Gloucester Road Wan Chai Hong Kong	Ms Monifa Ho / Mr. Joseph Law  Tel: 2584 8500	No. 1 Pump Room near West Bridge	Notes of Meeting No. 60 & Notes of Meeting No. 60 between Building Owners, CEDD & AACL
China Resources Building	Room 1206-1210 12/F, China Resources Building 26 Harbour Road Hong Kong	Mr. Dave Law  Tel: 2828 5688	No. 5 – 7 Pump Room near East Bridge	Notes of Meeting No. 60 & Notes of Meeting No. 60 between Building Owners, CEDD & AACL
Great Eagle Centre	3/F Great Eagle Centre 23 Harbour Road Wan Chai Hong Kong	Ms. Silvia Lam  Tel: 2879 2120	No. 8-10 near East Bridge	Notes of Meeting No. 60 & Notes of Meeting No. 60 between Building Owners, CEDD & AACL
Hong Kong Convention and Exhibition Centre	1 Expo Drive Wan Chai Hong Kong	Mr. Lap Shieh  Tel: 2582 8888  Mr. P K Chan  Tel: 2582 7070	North tip of HKCEC island (P6)	Notes of Meeting No. 60 & Notes of Meeting No. 60 between Building Owners, CEDD & AACL



Your Ref :

Our Ref : WDII/(GEN)/M30/610/WB00408

**Distribution List**

Designated Owners	Address and Contact Telephone Number	Contact Person	Existing Pumping Station Location	Enclosure
Convention Plaza (managed by Kiu Lok Service Management Co., Ltd.)	Room 1108, Office Tower, Convention Plaza 1 Harbour Road Wan Chai Hong Kong	Mr. Raymond Chan  Tel: 2802 7966  Mr. C. K. Wu  Tel: 2802 7966	At Semi-circular Promenade Deck	Notes of Meeting No. 60 & Notes of Meeting No. 60 between Building Owners, CEDD & AACL
Civil Engineering and Development Department	13th Floor North Point Govt Offices 333 Java Road North Point Hong Kong	Mr. Bosco Chan  Tel: 2231 4438	---	Notes of Meeting No. 60 & Notes of Meeting No. 60 between Building Owners, CEDD & AACL (w/o CD)
Hong Kong Trade Development Council	38/F, Office Tower Convention Plaza 1 Harbour Road Wan Chai Hong Kong	Ms. Jocelyn Chung  Tel: 2584 4590	---	Notes of Meeting No. 60 & Notes of Meeting No. 60 between Building Owners, CEDD & AACL
AECOM Asia Co. Ltd. (Design Office)	13/F, Grand Central Plaza, Tower 2 138 Shatin Rural Committee Road Shatin, N.T.	Mr. Sunny Tan  Tel: 3922 8765	---	Notes of Meeting No. 60 & Notes of Meeting No. 60 between Building Owners, CEDD & AACL (w/o CD)
Chun Wo – Leader Joint Venture (Contract No. HK/2009/01)	5C, Hong Kong Spinners Industrial Building, Phase 1 601-603 Tai Nan West Street Cheung Sha Wan Kowloon Hong Kong	Mr. Andy Yu  Tel: 2587 1900	---	Notes of Meeting No. 60 (w/o CD)
Chun Wo – CRGL Joint Venture (Contract No. HK/2009/02)	5C, Hong Kong Spinners Industrial Building, Phase 1 601-603 Tai Nan West Street Cheung Sha Wan Kowloon Hong Kong	Mr. K. K. Yuen  Tel: 9498 1213	---	Notes of Meeting No. 60 (w/o CD)



SA2 to Agreement No. CE 54/2001 (CE)  
Wan Chai Development Phase II – Design and Construction for Trunk Road Tunnel Option

Notes of Progress Meeting No. 60 on Re-provisioning of Sea Water Cooling Facilities

Date : 30 July 2015 (Thursday)  
Time : 14:30 – 17:15  
Location of Meeting : Conference Room B and C, AACL PRE's Site Office

Present

Company / (Position)

Attendees:

Civil Engineering and Development Department (CEDD)

Mr. Jimmy LING            Engineer  
Mr. Jackel TANG           Engineer  
Mr. Timothy CHU           Engineer

Colin Chan Consultant Engineers Ltd. (Colin)

Mr. Colin CHAN            Director  
Mr. Sammy MAK           Engineer } Contract No. HK/2009/02 only

Kiu Lok Service Management (Convention Plaza – CP)

Mr. S S CHAN              Engineer  
Mr. Terence WOO          Senior Engineer

Shui On Centre Property Management Ltd. (SOC)

Mr. Danny CHAN          Technical Manager

Great Eagle Centre (GEC)

Mr. Felix CHAK            Senior Engineer  
Mr. M F FOK                CEM  
Mr. C K CHAN              Senior Supervisor

Present

Company / (Position)

Attendees:

China Resources Property Ltd. (CRB)

Mr. Paul HUNG Building Services Inspector

Sun Hung Kai Real Estate Management (SHK)

Mr. C K LEE Senior Engineer  
Mr. H N KONG Technical Officer  
Mr. C H LEUNG Technician

AECOM Asia Co. Ltd. (AACL)

Mr. Sunny NG Senior Resident Engineer  
Mr. K C MAK Senior Quantity Surveyor  
Mr. Eliot LIU Resident Engineer  
Mr. Kevin Wong Assistant Resident Engineer  
Mr. Paul YIP Assistant Resident Engineer (Notes Taker)  
Mr. K H NG Assistant Resident Engineer (Notes Taker)

Chun Wo – Leader Joint Venture (CWLJV)

Mr. Kenneth CHAN Construction Manager

Chun Wo – CRGL Joint Venture (CWCRGLJV)

Mr. K K YUEN Site Agent  
Mr. Pak LI Senior Engineer  
Mr. T K LEUNG Building Services Manager



<u>Item</u>	<u>Discussion</u>	<u>Action</u>
<b>1.0</b>	<b><u>Presentation of Contract No. HK/2009/01</u></b>	
	CWLJV reported the construction status of the re-provisioning of sea water cooling facilities under CEDD Contract HK/2009/01 for Convention Plaza (CP), Shui On Centre (SOC), Hong Kong Academy for Performing Arts (HKAPA), China Resources Building (CRB), Great Eagle Centre (GEC) and Harbour Centre (HC). The salient points are summarized as below:-	CWLJV
	1. <u>Inspection status for rectification works</u>	
	Rectification works of E & M facilities for pumping stations P1, P3 and P4 were completed.	
	2. <u>Cooling Mains Works Progress at East of HKCEC</u>	
	The commissioning of discharge cooling mains for P5, P7 and P9 were completed.	
<b>2.0</b>	<b><u>General Discussion on Contract No. HK/2009/01</u></b>	
2.1	Regarding the leakage problem of the supplied butterfly valves for pumping stations P1, P3 and P4. CWLJV would formal submit the clarification letter from their supplier to AACL for assessment.	CWLJV
2.2	The new discharge pipes for GEC/HC and CRB had been commissioned on 14 June 2015. CWLJV was urged to complete the outstanding works and arrange the handover inspection with building owners as early as possible. CWLJV advised that all outstanding works for GEC/HC and CRB would be completed by the 3 <sup>rd</sup> week of August 2015.	CWLJV
2.3	AACL tabled in the meeting the proposed logo on chamber cover for the combined access chamber of discharge pipelines of BG and BI. Building Owners of GEC/HC and CRB had no comment on the proposal. AACL's letter ref. WDII/(HK/2009/01)/C50/200.6/B15533 dated 14 July 2015 refers.	Noted
<b>3.0</b>	<b><u>A.O.B. for Contract No. HK/2009/01</u></b>	
3.1	CWLJV advised that the regular inspection of the silt screen was being carried out every month and the screen was found in good condition. CWLJV advised that the silt screen for P1, P3 and P4 would be removed in the following week. Building Owners of P1, P3 and P4 have no objection to such arrangement. CWLJV would advise the works schedule to AACL for advance notification accordingly.	CWLJV
3.2	Regarding the VO 135 Maintenance of penstock for P4, workshop in between AACL and SOC was carried out before the meeting, on 30 July 2015. SOC would further liaise with CEDD for solution accordingly.	SOC
3.3	CWLJV reported that the treatment works by infilling of grouting materials for the abandoned pipe at Fleming Road for GEC/HC and CRB had completed.	Noted

<u>Item</u>	<u>Discussion</u>	<u>Action</u>
<b>4.0</b>	<b><u>Presentation of Contract No. HK/2009/02</u></b>	
	<p>CWCRGLJV provided an update status of the re-provisioning of sea water cooling facilities for Great Eagle Centre and Harbour Centre (P7), Sun Hung Kai Centre (P8) and China Resources Building (P9). The status was summarized as follows:-</p> <p>1. <u>Report on progress of works (as of 30 July 2015):-</u></p> <p>i. P7, P8 and P9 – Installation of the terminal manhole cover was completed.</p> <p>ii. P7 and P9 – Treatment of the abandoned cooling water pipelines were completed on 29 and 19 July 2015 respectively.</p> <p>2. <u>Forthcoming works:-</u></p> <p>i. P9 – To carry out water runoff test of multi-part cover on 6 August 2015.</p> <p>ii. P7 and P8 –Water runoff test of multi-part cover would be carried out after the following works:-</p> <ul style="list-style-type: none"> <li>• The completion of butterfly valve replacement works inside the pumping station of P7 and P8 pumphouses.</li> <li>• The completion of AVR installation inside P8 pumphouse.</li> </ul> <p>iii. Completion of the remaining E&amp;M outstanding works and defects.</p>	Noted
<b>5.0</b>	<b><u>General Discussion on Contract No. HK/2009/02</u></b>	
5.1	CWCRGLJV reported that 99%, 99% and 99% of the outstanding and defective E&M works for P7, P8 and P9 respectively were completed. CWCRGLJV also stated that they completed all the outstanding works and defects except the rectification of butterfly valves in P7 and P8 pumping stations and AVR installation in P8 pumping station.	CWCRGLJV
5.2	CWCRGLJV reported that the additional pneumatic devices for access metal covers of P7 and P8 were completed and handed over during joint inspection with Building Owners held on 22 June 2015.	CWCRGLJV
	For P9 CRB, CWCRGLJV informed that the quotation of the additional pneumatic device for access metal cover was expired and a confirmation letter would be issued to AACL for their forward submission to Building Owner.	
<b>6.0</b>	<b><u>A.O.B. for Contract No. HK/2009/02</u></b>	
6.1	CWCRGLJV reported that the treatment of the abandoned cooling water pipelines of P7 and P9 were completed on 29 July 2015 and 19 July 2015 respectively. Reinstatement of road surface at Great Eagle footpath would be completed by 7 August 2015.	CWCRGLJV



<u>Item</u>	<u>Discussion</u>	<u>Action</u>
6.2	CWCRGLJV stated that rectification work for water seepage via the structure of P7, P8 and P9 was completed. Building Owners inspected the pumping station and had no adverse comment. CWCRGLJV stated that water runoff test to the multi-part covers in accordance with the manufacturer's recommendations would be conducted once the completion of butterfly valve replacement works inside the pumping stations. Water runoff test for P9 was scheduled at 14:00 on 6 August 2015. CWCRGLJV would confirm the date via sending email to AACL and Building Owner. AACL stated that the proposal of the water runoff test and tentative programme were forwarded to Building Owners on 22 June 2015.	CWCRGLJV
6.3	SHK expressed concern on the high voltage trip of the electro-chlorinator of P8 cooling water pumping station. CWCRGLJV stated that the AVR was delivered to site and installation was in progress. Testing and commissioning was schedule at 14:30 on 1 August 2015.	CWCRGLJV
6.4	In regard to the rectification of defective butterfly valves at P7,P8 and P9 cooling water pump houses, AACL stated that the Contractor's revised rectification proposal and the works programme was submitted to Building Owners. The butterfly valve replacement work of P9 was completed on 14 June 2015. Building Owners of P7 and P8 would like to have a separate meeting to discuss on this issue.	CWCRGLJV
	Building Owners of P9 requested CWCRGLJV to quote the source / reference of the proposed 30 days warranty period of the replaced disc for rectified butterfly valves as stated in the proposal. CWCRGLJV would check and further advise the Building Owners.	
6.5	CWCRGLJV advised Building Owners to strictly follow the valve and penstock supplier's operation maintenance guidelines as included in the O&M Manual, such as regular operations of the valves and penstocks in order to keep the good maintenance of the new equipment at P7, P8 and P9 cooling water pumping stations in good condition. Building Owner of P7 stated that maintenance procedure for the butterfly valves was not included in the O&M Manual, CWCRGLJV would further check and forward relevant information to Building Owner.	CWCRGLJV
6.6	CWCRGLJV stated that the terminal manhole cover for P7, P8 and P9 were installed and handed over to Building Owners.	Noted
6.7	Building Owner of P7 stated that the chlorinator of the water pumping station of P7 could not be run in low flow operation. CWCRGLJV reported that an inspection with the supplier was conducted and no malfunction of the chlorinator was found during the testing. Building Owner of P7 stated that the problem occurred occasionally, CWCRGLJV would further advise the lowest flow setting of the chlorinator to Building Owner of P7.	CWCRGLJV

<u>Item</u>	<u>Discussion</u>	<u>Action</u>
6.8	Building Owner of P8 stated that 4 no. of penstocks were found malfunction. AACL advised that CWCRGLJV could carry out investigation to find out the cause leading to the malfunction of the penstocks. However, AACL reminded Building Owner of P8 that since fully open and close operation of the penstocks had been demonstrated satisfactory at the time of handover, the cost of the investigation would be reimbursed to CWCRGLJV if the cause leading to the malfunction was found not related to CWCRGLJV. The Building Owner of P8 noted and agreed to the arrangement. AACL would further discuss with CWCRGLJV and advise Building Owner.	CWCRGLJV
6.9	Building Owner of P7 stated that the AVR No. 2 was failed to regulate one of the phase voltage. CWCRGLJV / AACL would check and advise the date of hand over of AVR to Building Owner of P7.	CWCRGLJV / AACL

**7.0 Date of Next Meeting**

The next meeting will be held on 27 August 2015, 14:30.



Wan Chai Development Phase II - Meeting Attendance List

Contract No: C1212

Date: 3 July 2005

Time: 10:30

Place: Conference Room B02

Subject: Project Meeting re. work on re-provisioning of Sewer Water Collecting Facilities

No.	Name	Company	Position	Contact No.
1	WONG Kiu KANG	KLSM	E	
2	WONG CHUN FAI	KLSM	SE	
3	EM DANNY (HAN)	Glaxi Co	TM	
4	<del>EM</del> Jimmy Lim	CTED	SE/4 (atg)	
5	Jackal Tang	LEOD	E	
6	SUNNY NG	AECOM	SRE	
7	KENNETH (HAN)	CWLI	CM	
8	C. K. Chan	GEC	S.C	
9	M. F. PAK	GEC	CEM	
10	Felix Chab	GEC	SE	
11	Paul Hung	CRPL	BSI	
12	Long Cheung	SHK	TL	
13	H.N. Kong	SHK	TD	
14	C.K. Lee	SANK	SE	
15	Colin Chan	Colin Chan Assoc	Dir.	
16	Sammy Pak	-/-	Genr.	
17	Timothy Chin	CBDD	EA	
18	KK Yuen	CWCRAL JV	SA	
19	TK Leung	=	BSM	
20	Li Pak	SE	S.E	

Wan Chai Development Phase II - Meeting Attendance List

Contract No. \_\_\_\_\_

City \_\_\_\_\_

Date \_\_\_\_\_

Time \_\_\_\_\_

Subject \_\_\_\_\_

No.	Name	Company	Position	Contact No.
1	Eliot Lin	AACL	RE	
2	Paul Yip	"	ARE	
3	Kenn Wong	"	ARE	
4	Ng K. Hui	"	ARE	
5	MAK Kok Ching	"	SQS	
6				
7				
8				
9				
10				
11				
12				
13				
14				
15				
16				
17				
18				
19				
20				

**From:** Perseus So <sre15@wd2-aecom.com>  
**To:** "wendy.ng@leadercon.com.hk" <wendy.ng@leadercon.com.hk>

---

**Date:** Monday, August 17, 2015 12:08PM  
**Subject:** FW: intake temporary shell jacket inlet screen no.1 damage at P5 Pump Station

---

---

**From:** Perseus So  
**Sent:** Tuesday, August 11, 2015 1:14 PM  
**To:** 'wendy.ng@leadercon.com.hk'  
**Subject:** FW: intake temporary shell jacket inlet screen no.1 damage at P5 Pump Station

Dear Wendy,

FYI, please.

Regards,

Perseus So

Senior Resident Engineer

Wan Chai Development Phase II

AECOM Asia Co. Ltd.

D:+852 3519 9001 M:+852 9325 1395

E: [sre15@wd2-aecom.com](mailto:sre15@wd2-aecom.com)

*This communication is intended for the sole use of the person(s) to whom it is addressed and may contain information that is privileged, confidential or subject to copyright. Any unauthorized use, disclosure or copying of this communication is strictly prohibited. If you have received this communication in error, please contact the sender immediately. Any communication received in error should be deleted and all copies destroyed.*

Please consider the environment before printing this page.

**From:** dawnchan@emsd.gov.hk [mailto:dawnchan@emsd.gov.hk]  
**Sent:** Saturday, August 08, 2015 2:41 PM  
**To:** Sunny Ng  
**Cc:** andy.yu@leadercon.com.hk; chcho@emsd.gov.hk; Gloria Tang; ellis\_ngky@emsd.gov.hk; hkip@emsd.gov.hk; Kenneth Chan (kenneth.chan@chunwo.com); Perseus So; swli@emsd.gov.hk; wllsang@emsd.gov.hk  
**Subject:** 回覆: intake temporary shell jacket inlet screen no.1 damage at P5 Pump Station

Dear Mr. NG

Noted and thanks for your prompt action.  
Should you have any coordination work on this matter, please feel free to contact our Mr. IP at 2338 9394.

Regards

H.CHAN  
AI/GES/HK2D  
Tel:3427 3096

寄件者: Sunny Ng <sre9@wd2-aecom.com>  
收件者: "dawnchan@emsd.gov.hk" <dawnchan@emsd.gov.hk>  
副本抄送: "chcho@emsd.gov.hk" <chcho@emsd.gov.hk>, "wllsang@emsd.gov.hk" <wllsang@emsd.gov.hk>, "ellis\_ngky@emsd.gov.hk" <ellis\_ngky@emsd.gov.hk>, "swli@emsd.gov.hk" <swli@emsd.gov.hk>, "hkip@emsd.gov.hk" <hkip@emsd.gov.hk>, "andy.yu@leadercon.com.hk" <andy.yu@leadercon.com.hk>, "Kenneth Chan (kenneth.chan@chunwo.com)" <kenneth.chan@chunwo.com>, Perseus So <sre15@wd2-aecom.com>, Gloria Tang <cre@wd2-aecom.com>  
日期: 08/08/2015 12:26  
主旨: RE: intake temporary shell jacket inlet screen no.1 damage at P5 Pump Station

Dear Mr. Chan,

Further to below email, please be advised that Contractor under Contract No. HK/2009/01 is going to deploy diver for the removal of captioned silt screen and silt curtain (shell jacket) and you will be advised of the exact date of removal accordingly.

Regards  
Sunny NG

**From:** Sunny Ng  
**Sent:** Tuesday, August 04, 2015 9:42 AM  
**To:** 'dawnchan@emsd.gov.hk'  
**Cc:** chcho@emsd.gov.hk; wllsang@emsd.gov.hk; ellis\_ngky@emsd.gov.hk; swli@emsd.gov.hk; hkip@emsd.gov.hk; andy.yu@leadercon.com.hk; Kenneth Chan (kenneth.chan@chunwo.com); Perseus So  
**Subject:** RE: intake temporary shell jacket inlet screen no.1 damage at P5 Pump Station



Dear Mr. Chan,

Your email is noted and I have passed the captioned message to my contractor for necessary follow up. You will be updated the status accordingly.

Regards  
Sunny NG

**From:** dawnchan@emsd.gov.hk[mailto:dawnchan@emsd.gov.hk]  
**Sent:** Saturday, August 01, 2015 2:24 PM  
**To:** Sunny Ng  
**Cc:** chcho@emsd.gov.hk; wltsang@emsd.gov.hk; ellis\_ngky@emsd.gov.hk; swli@emsd.gov.hk; hkip@emsd.gov.hk  
**Subject:** 轉寄: intake temporay shell jacket inlet screen no.1 damage at P5 Pump Station

Dear Mr. NG

Refer to our colleague report (please see the attachment for details), please take remedial action soonest (repair/take down the silt curtain) to avoid our equipment has been damaged by defective silt curtain. Thank you.

Regards

H.CHAN  
AI/GES/HK2D  
Tel:34273096

----- 轉寄者AEIGESHK2D/HQ/EMSD 於01/08/2015 14:09 -----

寄件者: WS1WCT4HK2/HQ/EMSD  
收件者: AIGESHK2B/HQ/EMSD@EMSD, AEIGESHK2D/HQ/EMSD@EMSD  
副本抄送: IGESHK2B/HQ/EMSD@EMSD, SIGESHK2/HQ/EMSD@EMSD, EGESHK2/MTK/EMSD@EMSD  
日期: 01/08/2015 13:40  
主旨: intake temporay shell jacket inlet screen no.1 damage at P5 Pump Station

Dear sirs,

Found the temporary shell jacket was damage during maintenance work of inlet screen no.1 at P5 Pump Station in this morning (1 August 2015. see attached photos ) ,found a lot of solid waste into our intake and the **others party's**shell jacket cover loosen behind our inlet screen no.4 , it maybe blockage our seawater intake.

Best regards,

Benny

=====  
=====  
IMPORTANT: This electronic transmission and its enclosure, if any, contain

information intended only for the addressee(s) named. Any use, distribution, copying or disclosure by any other person in whole or in part is strictly prohibited. If you receive this transmission in error, please notify the sender by e-mail or telephone and delete the message and any attachment from your system.

Any comments, opinions or other information contained in this transmission that do not relate to the official business of the Electrical and Mechanical Services Department shall not be construed to be expressed or endorsed by the Department.

=====  
=====  
=====  
=====

**IMPORTANT:** This electronic transmission and its enclosure, if any, contain information intended only for the addressee(s) named. Any use, distribution, copying or disclosure by any other person in whole or in part is strictly prohibited. If you receive this transmission in error, please notify the sender by e-mail or telephone and delete the message and any attachment from your system.

Any comments, opinions or other information contained in this transmission that do not relate to the official business of the Electrical and Mechanical Services Department shall not be construed to be expressed or endorsed by the Department.

=====  
=====

Attachments:

Temporary inlet screen no.1 shell jacket damage on 1 August 2015.docx

**From:** Perseus So <sre15@wd2-aecom.com>  
**To:** "wendy.ng@leadercon.com.hk" <wendy.ng@leadercon.com.hk>  
**Cc:** "andy.yu@leadercon.com.hk" <andy.yu@leadercon.com.hk>

---

**Date:** Thursday, August 20, 2015 03:27PM  
**Subject:** FW: Removal of silt screen and silt curtain at the seawater intake for HKCEC

---

Dear Wendy,

For your information, please.

Regards,

Perseus So

Senior Resident Engineer

Wan Chai Development Phase II

AECOM Asia Co. Ltd.

D: +852 3519 9001 M: +852 9325 1395

E: [sre15@wd2-aecom.com](mailto:sre15@wd2-aecom.com)

*This communication is intended for the sole use of the person(s) to whom it is addressed and may contain information that is privileged, confidential or subject to copyright. Any unauthorized use, disclosure or copying of this communication is strictly prohibited. If you have received this communication in error, please contact the sender immediately. Any communication received in error should be deleted and all copies destroyed.*

*Please consider the environment before printing this page.*

---

**From:** Sunny Ng  
**Sent:** Thursday, August 20, 2015 3:27 PM  
**To:** pkchan@hkcec.com; Wai Tong Mak (makwaitong@hkcec.com)  
**Cc:** Gloria Tang; Perseus So  
**Subject:** Removal of silt screen and silt curtain at the seawater intake for HKCEC

Dear PK,

As spoken this morning (20 August 2015), you have no objection to allow our Contractor of Contract No. HK/2009/01 to remove the silt screen and silt curtain installed at the seawater intake for HKCEC at Expo Promenade next to Golden Bauhinia Square.

The removal works is scheduled to be commenced soon and you will be advised the updated schedule of the works accordingly.

Should you require additional information, please feel free to contact the undersigned or my colleague, Mr. Perseus So at 9325 1395

Thanks with regards

Sunny NG

9325 0661



**From:** wai\_kon\_ng@wsd.gov.hk  
**To:** wendy.ng@leadercon.com.hk  
**Cc:** kwok-leung\_chan@wsd.gov.hk, chi\_kong\_b\_lam@wsd.gov.hk, wai\_kon\_ng@wsd.gov.hk, leung\_chi\_lam@wsd.gov.hk

---

**Date:** Friday, August 28, 2015 04:22PM  
**Subject:** Re: WSD7 silt screen removal

History: ✪ This message has been replied to and forwarded.

---

Dear Wendy

Please proceeding with your plan and inform us before the removal works.

Best Regards,

WK NG  
IM/K(O)1  
2191 5115

**From:** wendy.ng@leadercon.com.hk  
**To:** wai\_kon\_ng@wsd.gov.hk  
**Cc:** andy.yu@leadercon.com.hk, wyman.wong@buildking.hk  
**Date:** 28/08/2015 16:18  
**Subject:** WSD7 silt screen removal

---

Dear Mr. NG,

Further our earlier conversation this afternoon, we would like to carry out the silt screen removal work st WSD7 (Kowloon South).

The date of removal will be confirmed later.

Please me know if you have any concern.

Thanks.

Regards,  
Wendy Ng  
Chun Wo - Leader Joint Venture  
HK/2009/01 Wan Chai Development Phase II  
Central - Wan Chai Bypass at HKCEC  
Direct Line: (852) 2162-9955  
Fax: (852) 2587-1878



**From:** pl\_yip@wsd.gov.hk  
**To:** wendy.ng@leadercon.com.hk  
**Cc:** andy.yu@leadercon.com.hk, kam\_yiu\_hong@wsd.gov.hk, pl\_yip@wsd.gov.hk, wyman.wong@buildking.hk

---

**Date:** Monday, August 31, 2015 02:46PM  
**Subject:** Re: WSD19 silt screen removal

History:       ↪ This message has been forwarded.

---

Dear Wendy,

We spoke.

I understand that the dredging and reclamation activities under the contract have been completed. I have no objection to your removal of the silt screens which prevent silt generated by the dredging and reclamation activities from entering the Sheung Wan Salt Water Pumping Station.

Regards,

Allen PL YIP  
Mechanical Engineer / Hong Kong (Operation)  
Hong Kong and Islands Region  
Water Supplies Department  
(Tel. 2880 2525)

**From:** wendy.ng@leadercon.com.hk  
**To:** pl\_yip@wsd.gov.hk, kam\_yiu\_hong@wsd.gov.hk  
**Cc:** andy.yu@leadercon.com.hk, wyman.wong@buildking.hk  
**Date:** 31/08/2015 09:55  
**Subject:** WSD19 silt screen removal

---

Dear Mr. Yip,

Further our earlier conversation this morning, we would like to carry out the silt screen removal work at WSD19 (Sheung Wan).  
The date of removal will be confirmed later.

Please let me know if you have any concern.

Regards,  
Wendy Ng  
Chun Wo - Leader Joint Venture  
HK/2009/01 Wan Chai Development Phase II  
Central - Wan Chai Bypass at HKCEC  
Direct Line: (852) 2162-9955  
Fax: (852) 2587-1878



**Appendix J**  
**EPD's Comments**

24 DEC 2012 11:36 FROM LCCL/LCECL/LMCLER TO 28341626 NO. 317 P. 1/003  
TO: 0907 C1

OUR REF: EP2/HA/S3/15 Pt.23  
YOUR REF: CL0907/03.09.00/00/5478/L  
TEL NO: 2835 2390  
FAX NO: 2591 0558  
E-MAIL: [redacted]  
HOME PAGE: http://www.epd.gov.hk

Environmental Protection Department  
Branch Office  
28th Floor, Southern Centre,  
130 Hennessy Road,  
West Chai, Hong Kong.

環境保護署  
西區辦事處  
軒尼詩道  
一百三十號  
德輔中心北座八樓

Urgent by Fax: 2634 1626  
27 December 2012

Chun Wo - Leader Joint Venture  
5C, Hong Kong Spinners Industrial Building Phase 1,  
601-603 Tai Nan West Street,  
Cheung Sha Wan,  
Kowloon, Hong Kong.  
(Attn: Mr. Paul Yu - Site Agent)

Chun Wo - Leader Joint Venture  
RECEIVED  
27 DEC 2012  
LETTER REF. NO. 1/091437/9  
VO/SI NO.

Dear Sir,

**Environmental Impact Assessment (EIA) Ordinance, Cap.499**  
**Environmental Permit (EP) No. FEP-02/356/2009**  
**Wan Chai Development Phase II - Central-Wan Chai Bypass**  
**Hong Kong Convention and Exhibition Centre**  
**EP Condition 2.9: Updated Silt Screen Deployment Plan (Revision 4)**

I refer to your letter under reference dated 15 November 2012, which was received by EPD on 26 November 2012, depositing the captioned submission as per Condition 2.9 of Further Environmental Permit No. EP-02/356/2009, reproduced below for your reference.

After consulting our Water Assessment Section, we find the submission needs to be revised as per our comments below:

- (1) Section 1.1: Please specify which party is responsible for the installation, maintenance, repairing (if necessary) and removal of the silt screens.
- (2) Section 2.2: In the 6th line, "wier" should read "water".
- (3) Section 4.2: Please specify a "boundary" for the "Nearby marine works".
- (4) Please provide a programme for the installation and removal of the silt screens.

Please revise and re-submit the captioned submission as per our comments above.

Yours faithfully,

*Billy C.W. MA*  
(Billy C.W. MA)

Environmental Protection Officer  
for Director of Environmental Protection

Condition 2.9: Submission of Silt Screen Deployment Plan  
2.9 The Permit Holder shall liaise with the owners and the operators of the sewer intakes as shown in Table 1 of this Permit on details of silt screen installation, maintenance and removal at the sewer intakes. The relative locations of the intakes are shown in Figure 4 and Figure 5 of this Permit for reference. At least two weeks prior to the commencement of the marine works, the Permit Holder shall deposit with the Director four hard copies and one electronic copy of a silt screen deployment plan to provide details of the design, operation and maintenance requirements of the silt screen systems. The silt screen deployment plan shall be certified by the EIA Leader and verified by the ABC as conforming to the relevant information and recommendations contained in the approved EIA Report (Register No. AEIAR-125/2002) and liaison results with the owners and the operators of the sewer intakes. The typical configuration of silt screens is shown in Figure 3 for reference. Silt screens shall be installed in seawater intakes prior to the commencement of the corresponding marine works in the vicinity as provided in the proposed silt screen deployment plan. To avoid refuse entanglement and to ensure representative impact monitoring results, silt screens shall be maintained and refuse around them shall be collected at regular intervals on a daily basis so that water behind the silt screen is kept free from floating debris during the impact monitoring period. (see notes 8 and 9)

本署傳真  
 OUR FAX:  
 本區傳呼  
 YOUR REP:  
 電話  
 TEL NO.:  
 圖文傳真  
 FAX NO.:  
 電子郵件  
 E-MAIL:  
 網址  
 HOMEPAGE: <http://www.epd.gov.hk>

(19) in EP2/H4/S3/13 Ft.26 Environmental Protection Department  
 Branch Office  
 28th Floor, Southern Centre,  
 180 Hennessy Road,  
 Wai Chai, Hong Kong.



環境保護署分處  
 香港灣仔  
 軒尼詩道  
 一百一十號  
 修頓中心十八樓

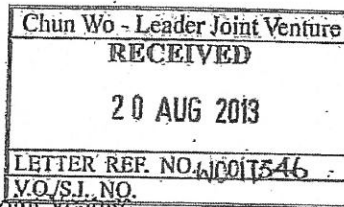

Urgent by Fax : 2587 1878

20 August 2013

Chun Wo - Leader Joint Venture  
 P.O. Box No. 28947,  
 Gloucester Road Post Office,  
 Hong Kong

(Attn: P.L. Yue - JV Board Representative)

Dear Sir,

**Environmental Impact Assessment (EIA) Ordinance, Cap.499**  
**Environmental Permit (EP) No. FEP-02/356/2009**  
**Wan Chai Development Phase II - Central Wai Chai Bypass at**  
**Hong Kong Convention and Exhibition Centre**  
**EP Condition 2.9: Silt Screen Deployment Plan (Rev.5)**

I refer to your letter under reference dated 24 July 2013, depositing the captioned submission as per Condition 2.9 of Further Environmental Permit No. FEP-02/356/2009, reproduced below for your reference.

After consulting our Water Assessment Section, we find the submission needs to be revised as per our comments below:

- (1) page 3 of 16 section 1.1 3rd line 5th word: "CWLJV" should be given in full name
- (2) page 8 of 16 section 4.2: The definition of "Nearby marine works" is still ambiguous. It should refer to "works within a certain distance" and not "the distance itself."
- (3) Programme: the program chart should make good so that the status of the silt screens between installation and removal, i.e., functioning (with maintenance etc.) also indicated, which can tally with the description in Section 4.1 (i.e. maintenance of silt screen).

Yours faithfully,

*Billy C.W. Ma*

(Billy C.W. MA)  
 Environmental Protection Officer  
 for Director of Environmental Protection



4 粵語  
OUR REF:  
來由編號  
YOUR REF:  
電話  
TEL NO.:  
傳真  
FAX NO.:  
電子郵件  
E-MAIL:  
網址  
HOMEPAGE: <http://www.epd.gov.hk>

(2) in EP2/H4/S3/15 Pt.32 Environmental Protection Department  
Branch Office  
28th Floor, Southern Centre,  
130 Hennessy Road,  
Wan Chai, Hong Kong.



環境保護署分處  
香港灣仔  
軒尼詩道  
一百三十二號  
樓頂中心廿八樓

Urgent by Fax : 2587 1878

11 September 2014

Chun Wo - Leader Joint Venture  
P.O. Box No: 28947,  
Gloucester Road Post Office,  
Hong Kong

(Attn.: Simon Liu - Site Agent)

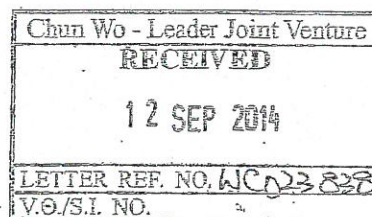

Dear Sir,

**Environmental Impact Assessment (EIA) Ordinance, Cap.499**  
**Environmental Permit (EP) No. FEP-02/356/2009**  
**Wan Chai Development Phase II - Central-Wan Chai Bypass at**  
**Hong Kong Convention and Exhibition Centre**  
**EP Condition 2.9: Silt Screen Deployment Plan (Rev.6)**

I refer to your letter under reference dated 19 August 2014, depositing the captioned submission as per Condition 2.9 of Further Environmental Permit No. FEP-02/356/2009, reproduced below for your reference.

After consulting our Water Assessment Section, we find the submission needs to be revised as per our comments below:

- (1) Some figures and texts in the appendixes (e.g. App.A - Location Plan; App.F - Arrange of Access Provision for Water Monitoring, etc) are so **blurred** and not easy to read, please provide figures with **higher resolution**;
- (2) Please add a paragraph to outline why amendment of plan is necessary at, say section 1.1 Introduction, to facilitate the general reader to follow the logic; and
- (3) Please review the submission to ensure the general fluency and to prevent minor grammatical mistakes.

Yours faithfully,

(Billy C.W. MA)

Environmental Protection Officer  
for Director of Environmental Protection



本署編號  
OUR REF:  
來函編號  
YOUR REF:  
電話  
TEL. NO.:  
圖文傳真  
FAX NO.:  
電子郵件  
E-MAIL:  
網址  
HOME PAGE: <http://www.epd.gov.hk>

(4) in EP2/H4/S3/15 Pt.34

**Environmental Protection Department  
Branch Office**

28th Floor, Southern Centre,  
130 Hennessy Road,  
Wan Chai, Hong Kong.



環境保護署分處  
香港灣仔  
軒尼詩道  
一百三十號  
修頓中心廿八樓

**Urgent by Fax : 2587 1878**

2 December 2014

Chun Wo – Leader Joint Venture  
P.O. Box No. 28947,  
Gloucester Road Post Office,  
Hong Kong

(Attn.: Simon Liu – Site Agent)

Dear Sir,

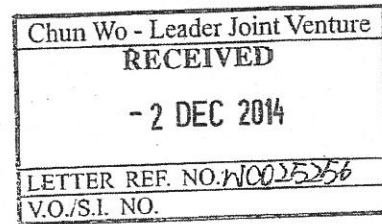

**Environmental Impact Assessment (EIA) Ordinance, Cap.499  
Environmental Permit (EP) No. FEP-02/356/2009  
Wan Chai Development Phase II - Central-Wan Chai Bypass at  
Hong Kong Convention and Exhibition Centre  
EP Condition 2.9: Silt Screen Deployment Plan (Rev.7)**

I refer to your letter under reference submitting the captioned Silt Screen Deployment Plan (the Plan) as per Condition 2.9 of Further Environmental Permit No. FEP-02/356/2009.

It is noted that the Plan has been certified by the Environmental Team (ET) Leader and verified by the Independent Environmental Checker (IEC) as conforming to the information and recommendations contained in the EIA report for the above Project.

Concerning the submission of the Plan, for ease of reference, the relevant Permit Condition is reproduced below:

**Submission of Silt Screen Deployment Plan**

2.9 *Liaison with the owners and the operators of the seawater intakes as shown in Table 1 of this Permit shall be conducted on details of silt screen installation, maintenance and removal at the seawater intakes. The indicative locations of the intakes are shown in Figure 4 and Figure 5 of this Permit for reference. At least two weeks prior to the commencement of the marine works, four hard copies and one electronic copy of a silt screen deployment plan shall be deposited with the Director to provide details of the design, operation and maintenance requirements of the silt screen systems. The silt screen deployment plan shall be certified by the ET Leader and verified by the IEC as conforming to the relevant information and recommendation contained in the approved EIA Report (Register No: AEIAR-125/2008) and liaison results with the owners and the operators of the seawater intakes. The typical configuration of silt screen is shown in Figure 3 for reference. Silt screens shall be installed at seawater intakes prior to the commencement of the corresponding marine works in the vicinity as presented in the finalised silt screen deployment plan. To avoid refuse entrapment and to ensure representative impact monitoring results, silt screens shall be maintained and refuse around them shall be collected at regular intervals on a daily basis so that water behind the silt screens be kept free from floating debris during the impact monitoring period. (see notes 8 and 9)*

Having reviewed the above submission, we find the submission generally in order. It will be placed in our EIAO Register Office for public information.

The captioned Plan enclosed in your above letter is deposited with the Director for fulfilling the above Permit Condition 2.9 from the environmental perspective as examined under the Environmental Impact Assessment Ordinance (EIAO) (Cap. 499) and does not absolve you/the project proponent/any person from any requirements or obligations under other laws in force in Hong Kong, nor the liabilities due to any conflicts, nuisance or damages that the proposed works may cause to third parties.

Yours faithfully,

(Steve T.S.L.I)

Senior Environmental Protection Officer  
for Director of Environmental Protection

c.c.

PM/HKI&I, CEDD  
AECOM  
ET Leader / LAM  
IEC / Environ

(Attn: Mr. Patrick Keung) Fax: 2577 5040  
(Attn: Ms. Gloria Tang) Fax: 3912 3010  
(Attn: Mr. Raymond Dai) Fax: 2882 3331  
(Attn: Mr. David Yeung) Fax: 3548 6988

c.c

S[MA]5, E(MA)31

China Wo - Leader Joint Venture			
Job No - CL9907			
Contract No. HK/2005/01			
Date:			
Position	Action	Info	Initial
JV Representative			
Site Agent			
Deputy Site Agent			W
Commercial Mgr			
Engineering Mgr			
Planning Eng.			
CM - Marine / XHWM			
CM - Tunnel			
CM - Waterworks			
Safety Dept			
Environmental Officer	✓		
QA/QC			
Managing GS			
Chief Surveyor			
Admin Officer			
HK Dept			
CLO			

傳呼號碼  
 OUR REF: (14) in EP2/H4/S3/15 Pt.39  
 傳真號碼  
 YOUR REF: CL0907/03.09.00.00/13315/L  
 電話  
 TEL NO.: 2835 2390  
 傳真號碼  
 FAX NO.: 2591 0558  
 電子郵件  
 E-MAIL:  
 網址  
 HOMEPAGE: http://www.opd.gov.hk

**Environmental Protection Department**  
**Branch Office**  
 28th Floor, Southorn Centre,  
 130 Hennessy Road,  
 Wan Chai, Hong Kong.

環境保護署分處  
 香港灣仔  
 軒尼詩道  
 一百三十號  
 修頓中心廿八樓

Urgent by Fax : 2587 1878

Chun Wo – Leader Joint Venture  
 P.O. Box No. 28947,  
 Gloucester Road Post Office,  
 Hong Kong

Chun Wo - Leader Joint Venture
RECEIVED
23 SEP 2015
LETTER REF. NO. WFO30742
V.O./S.I. NO.

23 September 2015

(Attn.: Andy Yu – Site Agent)

Dear Sir,

**Environmental Impact Assessment (EIA) Ordinance, Cap.499**  
**Environmental Permit (EP) No. FEP-02/356/2009**  
**Wan Chai Development Phase II - Central-Wan Chai Bypass at**  
**Hong Kong Convention and Exhibition Centre**  
**EP Condition 2.9: Silt Screen Deployment Plan (Rev.8)**

I refer to your letter under reference dated 7 September 2015, depositing the captioned submission as per Condition 2.9 of Further Environmental Permit No. FEP-02/356/2009, reproduced below for your reference.

After consulting our Water Assessment Section, we find the submission needs to be revised as per our comments below. Please submit the revised version to us for further review.

Item #01: page 3 of 20 (proposed amendment in yellow): Please provide documentary evidence to demonstrate that CWLJV can do the job as proposed wrt to all relevant contractual, legal provisions etc., including that there are indeed no more dredging work that call for the listed silt screens to prevail.

Item #02 section 2.3: page 5 of 20: So long as the site conditions permit, type 1 (for vertical seawall) or type 2 (for promenade decking) can be used so long as they can function as a silt screen intended in all respects covering design installation, maintenance and removal, and justifications with respect to the site conditions such as changes in seawall (e.g. changed to a vertical seawall) and reclamation configuration.

Item #03: page 9 of 20 section 4.5: Please ensure that the screens are properly maintained (until the screens are removed) to save the hassle otherwise e.g. to cover instances like some dead fish (could be as large as a dolphin / whale) get trapped in the silt screens and caused water quality issues.

Yours faithfully,

  
 (Billy C.W. MA)

Environmental Protection Officer  
 for Director of Environmental Protection

Condition 2.2: Submission of Silt Screen Deployment Plan

Liaison with the owners and the operators of the seawater intakes as shown in Table 1 of this Permit shall be conducted on details of silt screen installation, maintenance and removal at the seawater intakes. The indicative locations of the intakes are shown in Figure 4 and Figure 5 of this Permit for reference. At least two weeks prior to the commencement of the marine works, four hard copies and one electronic copy of a silt screen deployment plan shall be deposited with the Director to provide details of the design, operation and maintenance requirements of the silt screen systems. The silt screen deployment plan shall be certified by the ET Leader and verified by the IEC as conforming to the relevant information and recommendation contained in the approved EIA Report (Register No: AE/AR-125/2008) and liaison results with the owners and the operators of the seawater intakes. The typical configuration of silt screen is shown in Figure 3 for reference. Silt screens shall be installed at seawater intakes prior to the commencement of the corresponding marine works in the vicinity as presented in the finalised silt screen deployment plan. To avoid refuse entrapment and to ensure representative impact monitoring results, silt screens shall be maintained and refuse around them shall be collected at regular intervals on a daily basis so that water behind the silt screens be kept free from floating debris during the impact monitoring period. (see notes 8 and 9)

c.c.

PM/HKI&I, CEDD  
 AECOM  
 ET Leader / LAM  
 IEC / Environ

(Attn: Mr. Jason Cheung) Fax: 2577 5040  
 (Attn: Mr. Frankie Fan) Fax: 2587 1877  
 (Attn: Mr. Raymond Dai) Fax: 2882 3331  
 (Attn: Mr. David Yeung) Fax: 3465 2899

Chun Wo - Leader Joint Venture			
Job No - CL0907			
Contract No. HK/2009/01			
Date:	Position	Action	Info Initial
	JV Representative		
	Site Agent		✓
	Deputy Site Agent		
	Commercial Mgr		
	Engineering Mgr		
	Planning Eng.		
	CM - Marine / KHWM	✓	
	CM - Tunnel		
	CM - Waterworks		
	Safety Dept		
	Environmental Officer	✓	
	QA/QC		
	Managing QS		
	Chief Surveyor		
	Admin Officer		
	HR Dept		
	CLO		



